

REPORT OF COMPLETED WORKS -- SEACOAST FORTIFICATIONS  
(Gun and Mortar Batteries)

COAST DEFENSES OF SAN FRANCISCO, CAL.  
FORT WINFIELD SCOTT, CAL.  
BATTERY CRANSTON

1920

Form 1 Corrected to MARCH 1, [REDACTED]

No. of guns 2 Caliber 10" Carriage Dis. L.F.

Battery commenced -----	1897	Source of electric current	Central Power Plant: two 100-k.w. steam driven sets.
Battery completed -----	1898	Max. kw. required for lights	6.7 K.W.
Date of transfer -----	July 11, 1898	Max. kw. required for motors	19.4 K.W.
Material of construction ---	Concrete.	Present condition of battery	Good.
Portland or Rosendale cement	Portland	Rooms wet or dry -----	Dry.
Cost to date of transfer ---	\$55,431.97	How ventilated -----	Natural draft. 6" terra cotta vents from magazines terminating at traverse walls.
Connected to water supply ---	Yes.	Remarks-	
Connected to sewer -----	Yes.		
of latrine -----	Syphon.		
Type of data transmission ---	Telephone.		
Trunnion elevation in battery -----	199.9		
Datum plane -----	M.L.L.W.		

ARMAMENT.

Emplacement or mortar No.	Guns <del>at Mounts</del>						Carriages				
	Cal.	length	model	Serial No.	Manufacturer	mounted	Type	model	Serial No.	Manufacturer	Motor
1 -----	10"	30.6'	1888MII	7	Bethlehem S.Co.	Yes	L.F.	1896	29	Beth. Steel Co.	Retracting
2 -----	10"	30.6'	1888MII	13	" "	Yes	L.F.	1896	28	" "	"
3											
4											
5											
6											
7											
8											

HOISTS.

Emplacement Number	Type	Delivery	Motor						Date of transfer	Remodeled for long points.
			Serial No.	Maker	H.P.	Volts	RPM	Type of Control		
1 -----	T-R	Back	89	G.E.Co.	5	220	1060	R 67-A	Records destroyed	Yes.
2 -----	T-R	Back	88	G.E.Co.	5	220	1060	do.	Records destroyed	Yes.
3										
4										

See U.D. 2-20 Breech mechanisms to be removed, and store locally for use as spares. Guns themselves be not disposed of until studies at present in progress indicate whether or not it is desirable to retain parts for technical investigation. #7 gun fired 248 rounds.

See U.D. 2-20. Above carriages to be sold as scrap, retaining sufficient parts for the maintenance of the 4 carriages of this type which are being held at Ft. Rosecrans.

REPORT OF COMPLETED WORKS - SEACOAST FORTIFICATIONS  
(BATTERY PLAN)

COAST DEFENSES OF SAN FRANCISCO, CAL.  
FORT WINFIELD SCOTT  
BATTERY CRANSTON  
NO OF GUNS 2: CALIBER 10<sup>IN</sup>: DISAPPEARING CARRIAGE

CORRECTED TO DEC. 1919

FORM-7

1" = 0' 0" 50' 100' 150' FEET

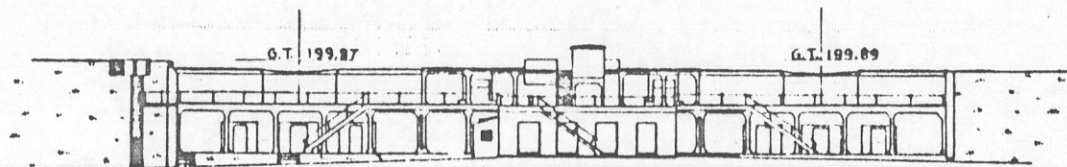
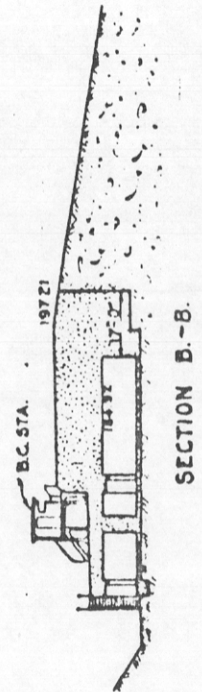
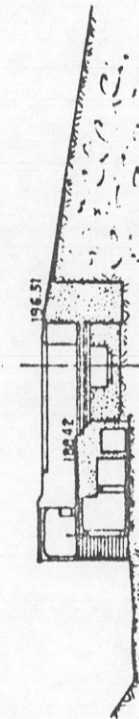
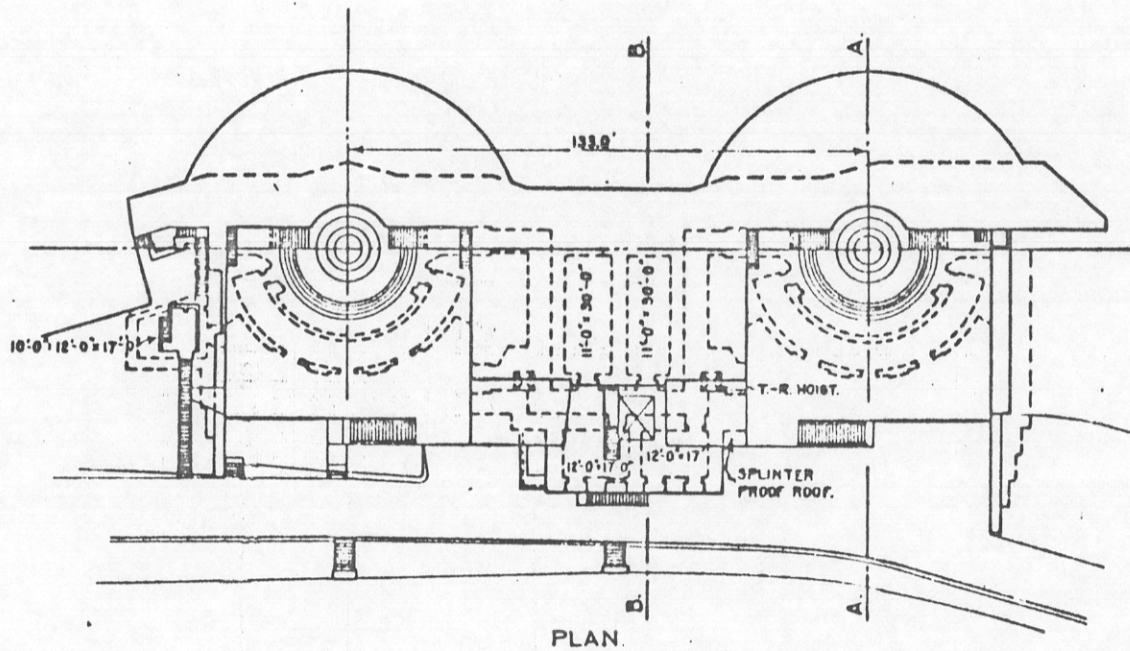



REPORT OF COMPLETED WORKS - SEACOAST FORTIFICATIONS  
(BATTERY PLAN)

HARBOR DEFENSES OF SAN FRANCISCO, CALIF.  
FORT WINFIELD SCOTT.  
BATTERY CRANSTON.

CORRECTED TO AUG. 1936.

NO OF GUNS 2: CALIBER 10<sup>IN.</sup>: DISAPPEARING CARRIAGE

FORM-7 *W.S. 1934, 660 B (9th C.A.) 3*

0 50 100 150 FEET

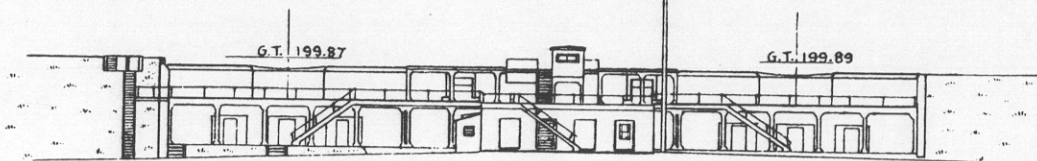
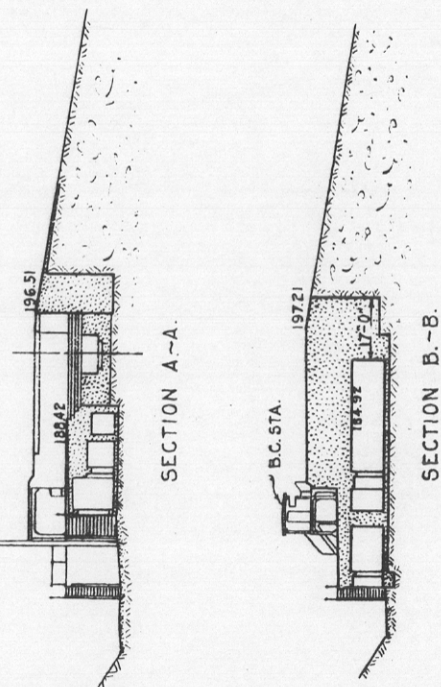
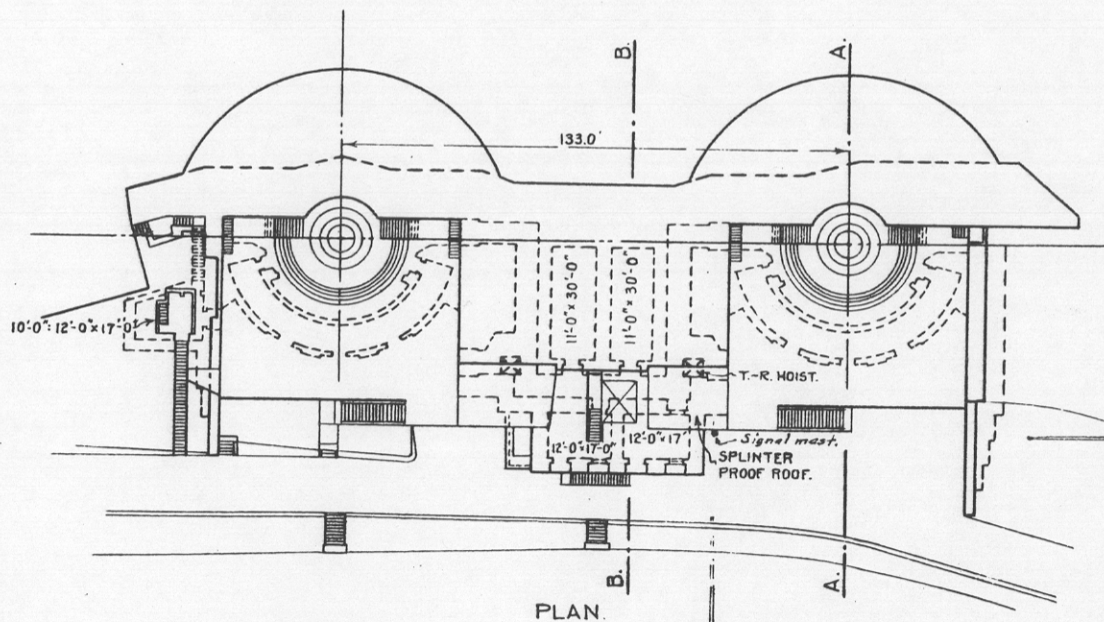

*See 660 B (9th C.A.) 3*

*A window was installed in doorway of the plotting room & an additional window was installed in the B.C. Station. These alterations together with other incidental changes being intended to put the battery in a more complete and up-to-date condition.*

# COAST DEFENSES OF San Francisco, California

FORT Winfield Scott BATTERY Cranston No. OF GUNS: 2 CALIBER: 10"

	EMPLACEMENT NUMBER 1.		EMPLACEMENT NUMBER 2.		EMPLACEMENT NUMBER 3.		EMPLACEMENT NUMBER 4.	
	FROM.	TO.	FROM.	TO.	FROM.	TO.	FROM.	TO.
1-a. Azimuth.	172°13'		190°13'					
b. Distance.	1157'		133'					
2-a. Model of Gun.	1888 M11		1888 M11					
b. " " Carriage	1896		1896					
c. Type of "	Dis.		Dis.					
3- Elevations of.								
a. Gun trunnions (in battery)	199.89		199.87					
b. Interior crest.	196.51		196.58					
c. Loading platform.	188.42		188.42.					
4- Angle of depression.	5°00'		5°00'					
5- Limiting azimuths of field of fire as determined by:	FROM.	TO.	FROM.	TO.	FROM.	TO.	FROM.	TO.
a. Construction of emplacement.	01	01	01	01	01	01	01	0
b. Interference by adjacent emplacements.	No interference							
c. Interference of other obstacles external to emplacement.	28°30'	33°00'	—	—				
d. Position of Ordnance stops.	10°18'	191°18'	9°36'	190°36'				

### NOTES.

1. Azimuth and distance of emplacement No. 2 are given with reference to No. 1; of No. 3, with reference to No. 2, etc. Azimuth and distance of No. 1, are given with reference to Fort Point (Latitude - 37°48' - 1209.9 meters. Light (Longitude - 122°28' - 868.9 "
3. Above plane of M.L.L.W.
- 5-c. Nature of obstacles: Superior slope embankment of Gun #1 Battery Marcus Miller.
- 2-c Use one of following abbreviations or designations: Dis.; Nondis.; Alt. gun-lift; Turret; Casemate; Ped.; B.P.



obsolete

REPORT OF COMPLETED WORKS -- SEACOAST FORTIFICATIONS.  
(Fire control or Torpedo Structures)

COAST DEFENSES OF SAN FRANCISCO.  
FORT. WINFIELD SCOTT.  
STRUCTURE PLOTTING ROOM, BATTERY CRANSTON.

1920

Form 2. Corrected to MARCH 1, 1911

Location	At rear of Traverse between Empl. #1 and #2.	Type of data transmission	Telephone and speaking tube.
Date of transfer	July 11, 1898*	Date of transfer	Tubes with battery.
Cost to that date	MODIFICATIONS \$113.00	Cost of data transmission equipment	Installed by Sig. Corps.
Type of construction		For tide stations give description of tide gauge	
(a) Roof	Concrete.	For datum points give Ports from which visible	
(b) Remainder of bldg.	Concrete.	For dormitories give stations served	
How concealed	In rear of baty traverse.	For cable hut give S.C. Type	
How protected	From direct fire by main battery traverse; from aerial bombs by concrete roof 3" thick.		
Heights above concealment	Below crest of traverse.		
Heights above protection	Below crest of traverse.		
Conspicuous at -- yards	Not visible from sea.		
Source of electric current	Central power plant.		
Kilowatts required	9 k.w.		
Type of lighting fixtures	2-3 light clusters; arm. w.t. fixtures.		
How heated	Not heated.		
Connected to water mains	No.		
Connected to sewer	No.		
Type of latrine	Use Battery latrine.		
Permanent or temporary installation	Permanent.		
Present condition	Good.		
Reference of site	173.55		
Reference of instrument axis			
Type of observing inst.			
Type of plotting board	W. & H. Model 1904 Gun.		
Type and capacity of crane			
Max. dimensions of reel handled			

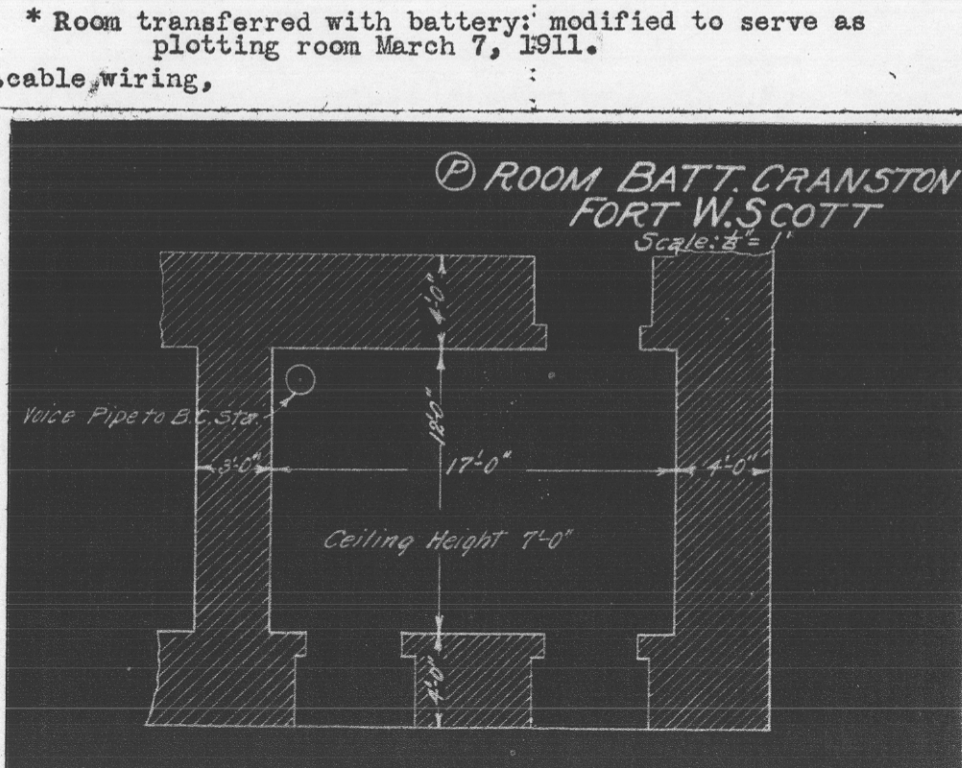

Obsolete

REPORT OF COMPLETED WORKS -- SEACOAST FORTIFICATIONS.  
(Fire control or Torpedo Structures)

COAST DEFENSES OF SAN FRANCISCO.  
FORT. WINFIELD SCOTT.  
STRUCTURE. B.C. CRANSTON.

Form 2.

Corrected to MARCH 1, 1920

Location	In rear of concrete traverse between Emp. #1 and #2.	Type of data transmission	Telephone and voice pipe.
Date of transfer	March 7, 1911.	Date of transfer	Pipe with station.
Cost to that date	\$2,250.00	Cost of data transmission equipment	Installed by Sig. Corps.
Type of construction		For tide stations give descrip- tion of tide gauge	
(a) Roof	Concrete.	For datum points give Forts from which visible	
(b) Remainder of bldg.	Reinforced concrete.	For dormitories give stations served	
How concealed	Partly by concrete traverse.	For cable hut give 3-C-Type	
How protected	Partly by concrete traverse.		
Heights above concealment	6'8"		
Heights above protection	6'8"		
Conspicuous at 2000 yards	from sea.		
Source of electric current	Central power plant thru Baty Cranston.		
Kilowatts required	.18 k.w.		
Type of lighting fixtures	w.t. fix. & iron conduit.		
How heated	Not heated.		
Connected to water mains	No.		
Connected to sewer	No.		
Type of latrine	Use battery latrine.		
Permanent or temporary installation	Permanent.		
Present condition	Good.		
Reference of site	188.14'		
Reference of instrument axis	199.75'		
Type of observing inst.	Azimuth Inst. Mod. 1915, #236.		
Type of plotting board			
Type and capacity of crane			
Max. dimensions of reel handled			

