

REPORT OF COMPLETED WORKS * SEACOAST FORTIFICATIONS
(Electric Plants)

COAST DEFENSES OF SAN FRANCISCO, CAL.

FORT BARRY

POWER FOR BATTERY MENDELL, F.C. AND MINE STATIONS.

Form 5.

Corrected to OCT.1,1921.

	Serial No.	Type	Size	Mfr.	Date of transfer	Cost	Con- dition	RPM	Belt or Direct Drive	Radiator for Engine No.	Fuel	Switchboard				
												Material	No. of Panels	Gen. Feed		
Boiler No.1																
No.2																
No.3																
Engine No.1	5454	GM 12	43/54 HP.	G.E.Co.	Nov.11,1910	----- \$6,818.13 -----	Good	560	Direct		gasln.		See L75.1	4	(9th C.A.)	
No.2	23	do.	do.	do.	do.		do.	do.	do.	do.	do.		115 DC	2	No	
No.3	5461				7/15/38		do.	do.	do.	do.	do.		115 DC	2	No	
Generator																
No.1	183202	MPC 6	25-k.w.	do.	do.		do.	do.	do.	do.						
No.2	177331	do.	do.	do.	do.		do.	do.	do.	do.						
No.3	183198															
Radiator																
No.1	None			Long-Turney	do.		do.	1050								
No.2	do.			do.	do.		do.	do.								
No.3	do.															
Motor-generator																
No.1																
No.2																
No.3																
Switchboard	43	P	80"x 82"	Tamton New Bed- ford Cop- per Co.	do.		do.						Marble	2	2	
Storage Battery																
Transformer																
No.1																
No.2																
No.3																
Auxiliaries																
No.1																
No.2																
No.3																

(2) See L75.1 (9th C.A.)
Eng. # 5461 moved 7/15/38 from Btry. Kirby, Ft. Baker

DISTRIBUTION OF K.W. -----

	Light	Power	Total
Battery Mendell	9.2	23.12	32.32
Switchboard room	1.1	0.0	1.1
Casemate	2.8	0.0	2.8
9 F.C.Stations	3.52	0.0	3.52
TOTAL	16.62	23.12	39.74

(1) See L75.1 (San Francisco) 50, 12th Incl.
Serial numbers of equipment to be moved from
Btry. Kirby, Ft. Baker, Power Plant are as follows;
Gas Engine # 5461, Generator # 183198, Radiator - No Number,
Fan Motor # 180444, Swb. Power Panel # 96461

*EMP'T. POWER PLANT
BATTERY MENDELL, FT. BARRY
CALIFORNIA*

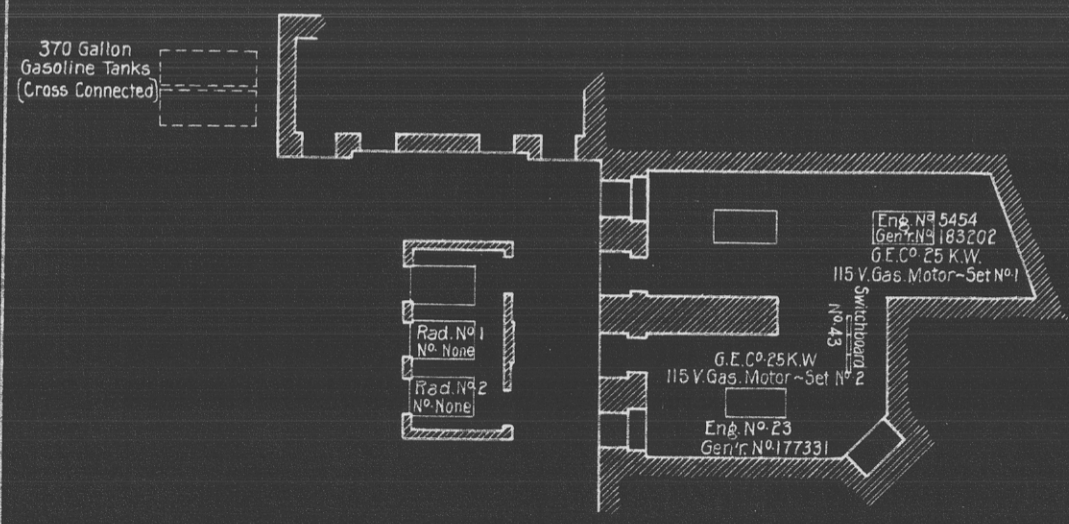

NOTE:~ For details of plant see
Transfer Plan 29-4-7 E.D. 38970/285

*EMP'T. POWER PLANT
BATTERY MENDELL, FT. BARRY
CALIFORNIA*

SCALE: $\frac{1}{16}$ IN. = 1 FT.

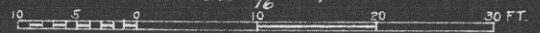

REPORT OF COMPLETED WORKS * SEACOAST FORTIFICATIONS
(Electric Plants)

COAST DEFENSES OF SAN FRANCISCO, CAL.

FORT BARRY

POWER FOR BATTERY E. J. WALLACE.

Form 5.

Corrected to OCT. 1, 1921

	Serial No.	Type	Size	Mfr.	Date of transfer	Cost	Condition	RPM	Belt or Direct Drive	Radiator for Engine No.	Fuel	Switchboard			
												Material	No. of Panels		
Boiler No.1															
No.2															
No.3															
Engine No.1	17492	GM 12	43/54 H.P.	G.E.Co.	6/29/21	1700.	Good	560	Direct		gasln.				
No.2	5474	do.	do.	do.	8/ 5/10	3409.	do.	do.	do.		do.	115 DC	2	No	
No.3											do.	115 DC	2	No	
Generator															
No.1	923974	MPC 6	25-k.w.	do.	6/29/21	See cost	do.	do.	do.						
No.2	189030	do.	do.	do.	8/ 5/10	See cost	do.	do.	do.						
No.3						See cost									
Radiator															
No.1	16989	FF 54		do.	6/29/21	See cost	do.	1150	do.						
No.2	None			Long-Turney.	8/ 5/10	See cost	do.	1050	do.						
No.3						See cost									
Motor-generator															
No.1															
No.2															
No.3															
Switchboard	808 Gen. 787 "		60" x 82"	Carlton-Mace Engr. Corp.		un-known	good.					Asbestos wood	2	1	
Storage Battery	473 Feed					530.									
Transformer															
No.1															
No.2															
No.3															
Auxiliaries															
No.1															
No.2															
No.3															

DISTRIBUTION OF K.W. --- Lights : Power : Total :

Battery Wallace --- 10.24 : *14.92 : 25.16

* Motors not yet installed.

① See 475.1 (9th C.A.) / -
Set # 5474 originally installed at Btry. Spencer,
moved to present position 6/29/21

POWER PLANT
BATTERY E.J. WALLACE, FT. BARRY

CALIFORNIA
SCALE: $\frac{1}{16}$ IN. = 1 FT.

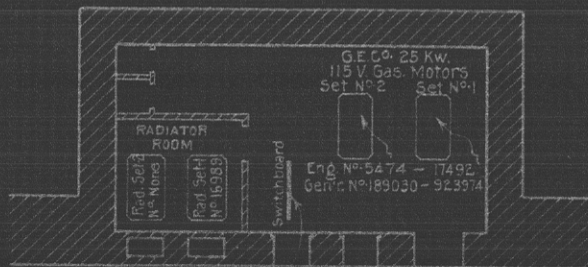

Feeder Panel No. 473
Panel Set No. 1 - No. 787
" " 2 - " 808

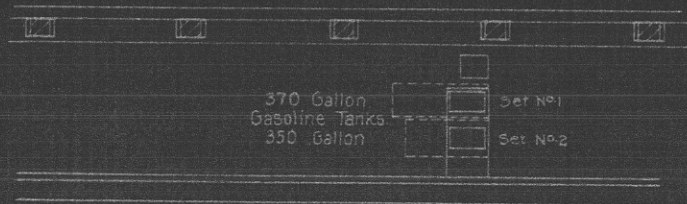

NOTE: - For details of plant see
Transfer Plan 55-4-5

REPORT OF COMPLETED WORKS * SEACOAST FORTIFICATIONS
(Electric Plants)

COAST DEFENSES OF SAN FRANCISCO, CAL.
FORT BARRY.

POWER FOR BATTERIES GUTHRIE, ALEXANDER AND O'RORKE.

Form 5.

Corrected to OCT.1, 1921

	Serial No.	Type	Size	Mfr.	Date of transfer	Cost	Con- dition	RPM	Belt or Direct Drive	Radiator for Engine No.	Fuel	Switchboard			
												Material	No. of Panels	Gen. Feed	
Boiler No.1															
No.2															
No.3															
Engine No.1	5459	GM 12	43/54 H.P.	G.E.Co.	11/11/10	----- \$7,221.70 -----	Good	560	Direct		gasln.	Volts	Wire	Used for Q.M. Power	
No.2	5456	do.	do.	do.	do.		do.	do.	do.		do.	115 DC	2	No	
No.3					do.		do.	do.	do.		do.	115 DC	2	No	
Generator															
No.1	183195	MPC 6	25-k.w.	do.	do.			do.	do.	do.					
No.2	183194	do.	do.	do.	do.			do.	do.	do.					
No.3								do.	do.	do.					
Radiator															
No.1	None			Long-	do.			do.	1050	do.	1				
No.2	do.			Turney	do.			do.	do.	do.	2				
No.3				do.	do.		do.	do.	do.						
Motor-generator															
No.1															
No.2															
No.3															
Switchboard	44	M	60"x 82"	Taunton New Bed- ford Cop- per Co.	do.		do.					Marble	2	1	
Storage Battery															
Transformer															
No.1															
No.2															
No.3															
Auxiliaries															
No.1															
No.2															
No.3															

DISTRIBUTION OF K.W.

	Light	Power	Total
Battery Guthrie	5.0	.0	5.0
Battery Alexander	8.2	.0	8.2
Battery O'Rorke	2.5	.0	2.5
Switchboard room	.4	.5	.9
TOTAL	16.1	.5	16.6

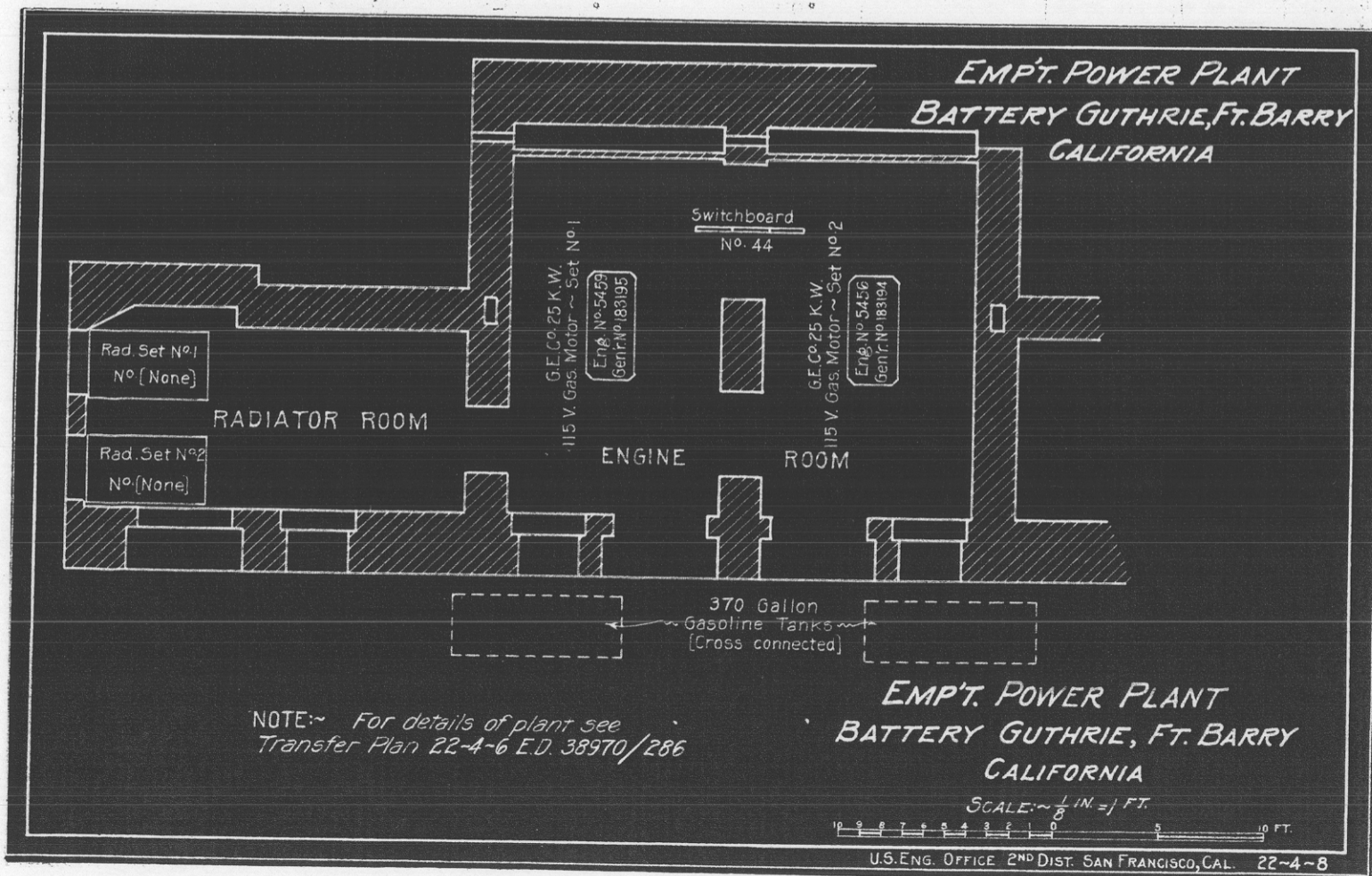

600.914(S2) 105090

REPORT OF COMPLETED WORKS - SEACOAST DEFENSES
(Power Station for Fire Control Stations)

HARBOR DEFENSES OF SAN FRANCISCO
FORT. BARRY, CALIFORNIA
STRUCTURE. POWER HOUSE (1-UNIT)

PART II (Modified) Corrected to June 1944

STRUCTURE: Near BC Wallace
 Location (by site description) Rodeo Hill, California
 Date of transfer. 11 July 1944
 Cost to that date. \$1,627.30 (incl. cables & trenching & all work at this location)
 Type (for observing stat. -- tower, dug-in, cottages, etc.) dug-in location)
 Type of construction.
 (a) Roof. Reinforced concrete
 (b) Remainder of bldg. Reinforced concrete
 How concealed. Earth backfill and vegetation.
 How protected. Earth backfill.
 Height above concealment. Not above concealment*
 Height above protection. Not above protection*
 Conspicuous at. 600 . . . yards. Conspicuous from sea.

UTILITIES: (Electrical and Power Distribution)
 Commercial Power. Yes - Commercial power source at Battery Wallace
 Generated Power. yes
 Source of generated power - standby power plant.
 Characteristics: Voltage. 120. . . AC on DC Phase 1
 Kilowatt output. 0.1 this station & 2.3 for other two stations.
 Number of generator sets installed. one
 Type and rating of generators. 3 KVA 125 V. AC 3 ϕ 60 cy.
 Generator serial No. 6633
 Furnished by. Signal Corps . . . installed by. USED
 Type of lighting fixtures . . . CSF-1
 Generator sets provide power for the following Stations: BC Wallace, B¹S¹ Wallace and this station.

Type of switch installed. 1. - 30 Amp. 2. Pole Fusible . . . Double-throw.
 Type and kind of power cable of each location 2 - #4 D.B. 1/c 600 V. from M.H. to Pwr. Hse.; 2-#4 D.B. 1/c 600 V. to B.C. Wallace and same spliced to existing cable serving B¹S¹ Wallace.
 Number and Type of Transformers. none

Switching instructions. Circuits to B.C. Wallace & B¹S¹ Wallace tied to Center (load) lugs of 30 A. 2 P. switch. Comm. power conn. to one side & standby conn. to other side of 30A. 2P. switch.

REFERENCES:
 Reference of site. 333.0 MLLW
 Floor elevation. 328.00 (0.00 at MLLW)

REMARKS
 * Front face of structure not concealed or protected.
 Cost is a portion of total amount of \$40,670 set up for Job No. SF FS-21 Dir. Cons. FS 1254.

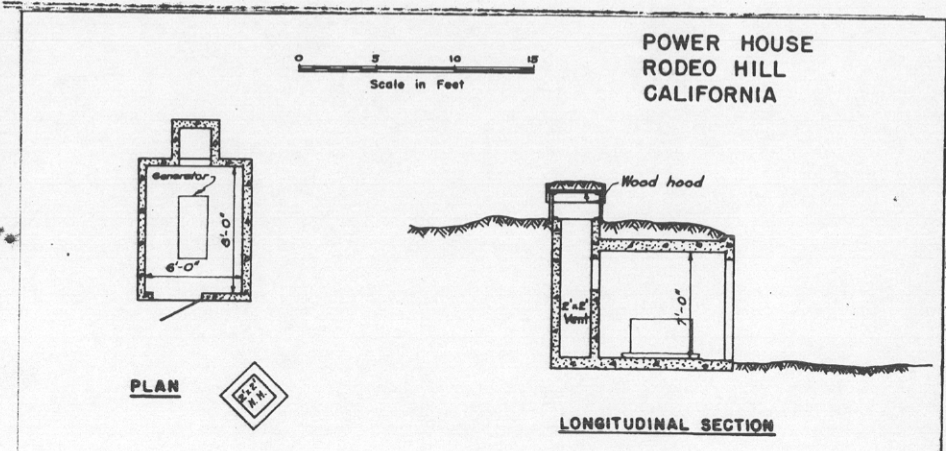

ED Form A-162B

600.914(SF)100548

CONFIDENTIAL

SPEKM-1

REPORT OF COMPLETED WORKS - SEACOAST DEFENSES
(Power Station for Fire Control Stations)

HARBOR DEFENSES OF SAN FRANCISCO
FORT. BARRY, CALIFORNIA
POWER ROOM, BATTERY MENDELL
STRUCTURE.

July 1944

PART II (Modified) Corrected to

STRUCTURE:

Location (by site description) Fort Barry, Calif.
Date of transfer. 31 July 1944
Cost to that date. \$337.46*
Type (for observing stat. -- tower, dug-in, cottages, etc.)
Type of construction.
(a) Roof
(b) Remainder of bldg.
How concealed.
How protected.
Height above concealment.
Height above protection.
Conspicuous at. yards.

UTILITIES: (Electrical and Power Distribution)

Commercial Power yes
Generated Power yes
Source of generated power -- standby power plant.
Characteristics: Voltage. 120 AC or DC. Phase 1
Hilowatt output. 0-9 for Base End Stations
Number of generator sets installed. One
Type and rating of generators. 3 KVA 125 V. AC 30 60 Cy
Generator serial No. 6582
Furnished by. Signal Corps installed by. USED
Type of lighting fixtures. none
Generator sets provide power for the following Stations: 2 Mines, BCS Chamberlin, B1st Smith

Type of switch installed. 60 A. 2 Pole, Double Throw.
30 A. fuse on generator side
Type and kind of power cable of each location. 2 - #4/b VCL
from Transf. M.H. to 60 A. 2 P.D.T. Switch in power room (Exist.
wire to Mendell Ridge removed from Swbd. & conn. to new 60 A.
none / 2 P.D.T. Switch.
Number and Type of Transformers.
One side of 60 A. 2 P.D.T. switch conn. to Gen. power & other side con. to standby generator. Feeder for stations shown above tied to center (load) lugs on this switch.

REFERENCES:

Reference of site
Floor elevation.

REMARKS: Generator installed in power room as shown on plan below. The information entered on this form applies only to the power room and the new 120 V. AC service to stations mentioned above.

Cost is for work from M.H. to power room & installation of 3 KVA generator. This is a portion of total amount of \$40,670 set up for Job No. SF PS-21, Dir. Cons. FS 1254.

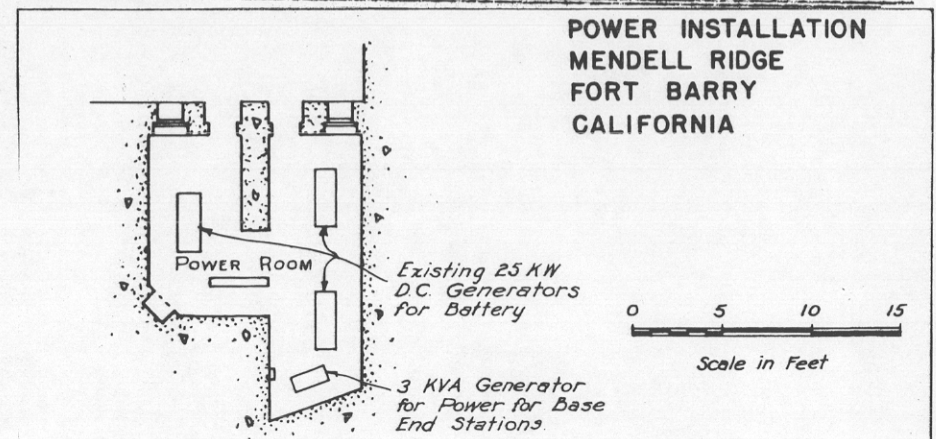

POWER ROOM PLAN

CONFIDENTIAL

ED Form A-162B

REPORT OF COMPLETED WORKS * SEACOAST FORTIFICATIONS
(Electric Plants)

COAST DEFENSES OF SAN FRANCISCO, CAL.

FORT BARRY

POWER FOR 60" SEARCHLIGHT NO.14 AND F.C.STATIONS. (1)

Form 5.

Corrected to OCT.1, 1921

	Serial No.	Type	Size	Mfgr.	Date of transfer	Cost	Con- dition	RPM	Belt or Direct Drive	Radiator: for Engine No.	Fuel	Switchboard				
												Material	No. of Panels	Gen. Feed		
Boiler No.1																
No.2																
No.3																
Engine No.1	5494	GM 12	43/54 HP.	G.E.Co.	4/25/11	----- \$5,500.80 -----	Good	560	Direct		gasln.		See 475.1 (9th C.A.) Volts 115 DC	Wirc 2	Used for P.M. Power No.	
No.2					do.		do.	do.	do.							
No.3					do.		do.	do.	do.							
Generator No.1	189213	MPC 6	25-k.w.	do.	do.		do.	do.	do.							
No.2					do.		do.	do.	do.							
No.3					do.		do.	do.	do.							
Radiator No.1	None			Long-Turney	do.		do.	do.	1050	do.	1					
No.2																
No.3																
Motor-generator No.1																
No.2																
No.3																
Switchboard	65		20"x 82"	Walker Co	4/25/11		do.						Marble	1		
Storage Battery																
Transformer No.1																
No.2																
No.3																
Auxiliaries No.1																
No.2																
No.3																

DISTRIBUTION OF K.W. Projector and Controller 18-k.w.; Shelter .12-k.w.; Power house .54-k.w.; 3 f.c. buildings .54-k.w.-----TOTAL 19.20 k.w.

(1) see 475.1 (9th C.A.) :-
No. 6 - Present approved H.D. project
No. 4 - Designated locally and referred in H.D. project as "Old number".
No. 14 - Designation when originally installed.

*POWER PLANT
SEARCHLIGHT No. 14 FT. BARRY
CALIFORNIA*

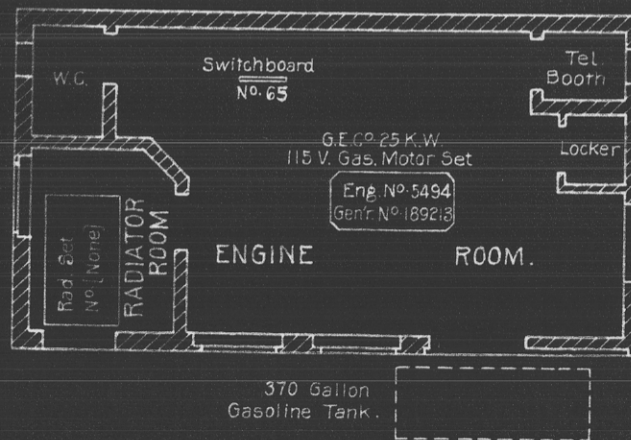

NOTE:~ For details of plant see
Transfer Plan 3-6-11 E.D. 38970/320

*POWER PLANT
SEARCHLIGHT No. 14 FT. BARRY
CALIFORNIA*

SCALE:~ 1/8" = 1 FT



REPORT OF COMPLETED WORKS * SEACOAST FORTIFICATIONS
(Electric Plants)

COAST DEFENSES OF SAN FRANCISCO, CAL.

FORT BARRY

POWER FOR 60" SEARCHLIGHT NO 15. ①

Form 5.

Corrected to OCT.1,1921

	Serial No.	Type	Size	Mfgr.	Date of transfer	Cost	Con- dition	RPM	Belt or Direct Drive	Radiator: for Engine No.	Fuel	Switchboard			
												Material	No. of Panels		
Boiler No.1													Gen.	Feed	
No.2															
No.3															
Engine No.1	5492	GM 12	43/54 H.P.	G.E.Co.	4/25/11	----- \$3,500.00 -----	Good.	560	Direct		gas.		See 675.1	(48 C.A.) 1	
No.2														Volts	Wires
No.3														115 DC	2
Generator															Used for Q.M. Power
No.1	189209	MPC 6	25-k.w.	do.	do.			do.	do.	do.					No
No.2															
No.3															
Radiator															
No.1	None			Long- Turney	do.			do.	1050	do.	1				
No.2															
No.3															
Motor-generator															
No.1															
No.2															
No.3															
Switchboard	68		20"x 82"	Walker Co.	do.		do.						Marble	1	
Storage Battery															
Transformer															
No.1															
No.2															
No.3															
Auxiliaries															
No.1															
No.2															
No.3															

DISTRIBUTION OF K.W. Projector and Controller 18-k.w.; Shelter .12 k.w.; Powerhouse .54 k.w. TOTAL 18.66 k.w.

① See 675.1 (48 C.A.) 1

- No. 5 - Present approved H.D. project
- No. 3 - Designated locally and referred to H.D. Project as "Old number".
- No. 15 - Designation when originally installed.

*POWER PLANT
SEARCHLIGHT N^o 15 FT. BARRY
CALIFORNIA*

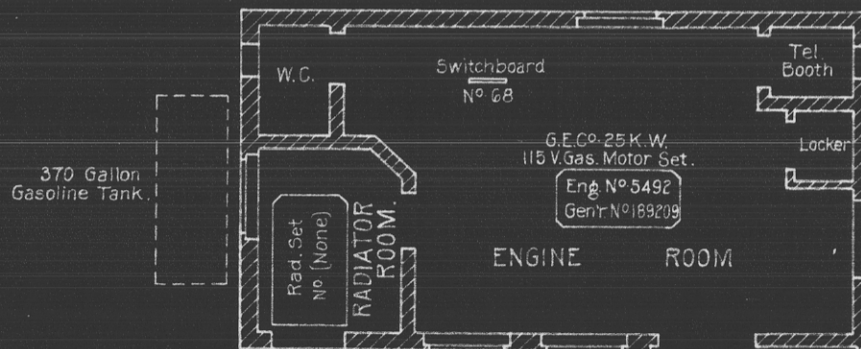

*NOTE:~ For details of plant see
Transfer Plan 3-6-12 E.D. 38970/321*

*POWER PLANT
SEARCHLIGHT N^o 15 FT. BARRY
CALIFORNIA*

SCALE: ~ 1/8" = 1 FT.

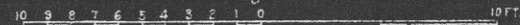

REPORT OF COMPLETED WORKS * SEACOAST FORTIFICATIONS
(Electric Plants)

COAST DEFENSES OF SAN FRANCISCO, CAL.

FORT BARRY

POWER FOR BATTERY RATHBONE & F.C. STATIONS.

Form 5.

Corrected to OCT. 1, 1921.

	Serial No.	Type	Size	Mfr.	Date of transfer	Cost	Con- dition	RPM	Belt or Direct Drive	Radiator for Engine No.	Fuel	Switchboard				
												Material	No. of Panels	Gen. Feed		
Boiler No.1																
No.2																
No.3																
Engine No.1	5460	GM 12	43/54 HP.	G.E.Co.	11/11/10	----- \$7,221.20 -----	Good	560	Direct		gasln.		See 675.1	675.1	(9th C.A.)	
No.2	5457	do.	do.	do.	do.		do.	do.	do.		gasln.		Volts	Wire	Used for QM Power	
No.3							do.	do.	do.		gasln.		115 DC	2	No	
Generator																
No.1	183199	MPC 6	25-k.w.	do.	do.			do.	do.	do.						
No.2	183193	do.	do.	do.	do.			do.	do.	do.						
No.3								do.	do.	do.						
Radiator																
No.1	None			Long-				do.	1050	do.	1					
No.2	None			Turney				do.	1050	do.	2					
No.3				do.												
Motor-generator																
No.1																
No.2																
No.3																
Switchboard	45	M	60"x 82"	Taunton- New Bed- ford Cop- per Co.	do.		do.						Marble	2	1	
Storage Battery																
Transformer																
No.1																
No.2																
No.3																
Auxiliaries																
No.1																
No.2																
No.3																

DISTRIBUTION OF K.W. ----- Light.

Battery Rathbone ---: 6.72
B' Rathbone, 1&2 ---: .18
B' Rathbone, 3&4 ---: .18
TOTAL K.W. -----: 7.08

AC commercial power to be supplied. 675.1 (San Fran.) CM 0050

EMP'T. POWER PLANT
BATTERY RATHBONE FT. BARRY
CALIFORNIA

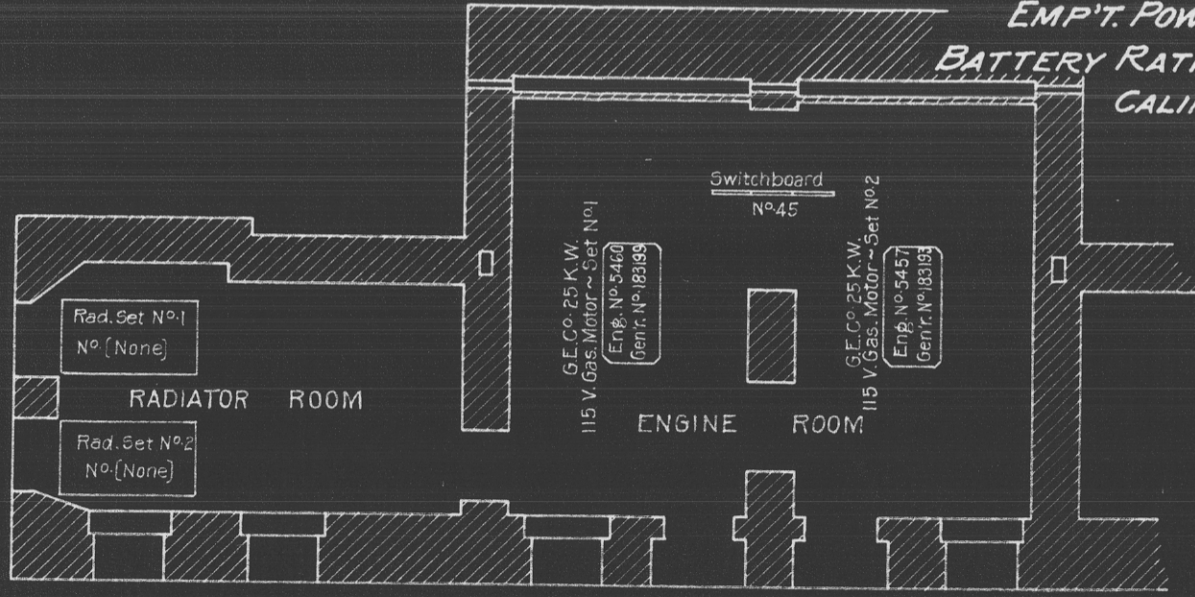

EMP'T. POWER PLANT
BATTERY RATHBONE, FT. BARRY
CALIFORNIA

370 Gallon
Gasoline Tanks
(Cross Connected)

SCALE: $\frac{1}{8}$ IN. = 1 FT.

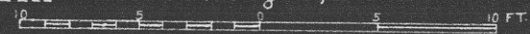

NOTE:~ For details of plant see Transfer Plan 32-4-7 E.D. 38970/287

600,914(SD)104548

REPORT OF COMPLETED WORKS - SEACOAST FORTIFICATIONS

HARBOR DEFENSES OF SAN FRANCISCO
FORT BARRY
STRUCTURE NETWORK LOGICAL STATION*

1045

PART II Corrected to July 1944

STRUCTURE:

x.
Location (by coordinates) y.
Location (by site description) On Hill 690' to left of
Date of transfer 11 Nov. 1910 / Capt. W. W. Merrill
Cost to that date 1625.00+
Type (for observing stat.--tower, dug-in,
cottages, etc.)
Type of construction
(a) Roof Wood tar and gravel
(b) Remainder of bldg. wood
How concealed Earth parapet
How protected Earth parapet
Height above concealment 8'
Height above protection 8'
Conspicuous at 1800 yards from sea

INSTRUMENTS & EQUIPMENT:

Type of observing inst.
Type of plotting board

DATA TRANSMISSION:

Type telephone
Date of transfer with station
Cost of data equipment installed by Signal Corps

TIDE STATION:

Give description of tide gauge

* See reverse side of this form for description of alterations and other work pertinent to the installation of power for Base and Stations accomplished in 1944.

UTILITIES:

Electric Power Battery Generator Plant
Source of
Characteristics: Voltage 112 V. Ac or DC..Phase
Kilowatts required
Type of lighting fixtures
Heat Not heated
How heated
Water Sewer
Connected to water mains No
Connected to sewer No
Type latrine No latrine

REFERENCE:

274.0
Reference of site
Reference of instrument axis

ED Form A-162B
16 Sept. 1943

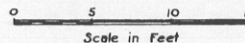

POWER INSTALLATION
BONITA RIDGE
FORT BARRY
CALIFORNIA

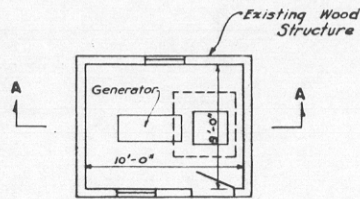

PLAN

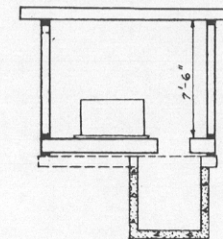

SECTION A-A

CONFIDENTIAL

Work Accomplished in 1944

This structure converted in to power house for installation of power for Base End Stations.
Wood louvers installed in two lower panels of door.

Telephone and equipment removed from wall and run of BX cable and plug receptacle salvaged.

Existing lamp receptacles removed and type CSF-1 fixtures installed.

Existing paper window covers replaced with removable plywood covers.

1 - 3KVA, 125 V. 60 Cy. MS standby generator installed.

1 - 100 A. 2 P. safety switch, fused 80 A.; 1 - 100 A. 2 P. non-fusible double-throw switch and

1 - 50A. 2 P. fusible switch installed.

Transformer - 10 KVA 3400/4160 V.Y. 120/240 V. 1 ϕ installed in existing transformer M.H.

2 - #2 WCL 600 V. cable, 120 V. 1 ϕ circuit from transformer to 100 A. service switch.

2 - #2 WCL, 120 V. 1 ϕ Cct. in vacant dist from 100 A. 2 P. D.T. Switch to existing M.H. & spliced to existing cable, furnishing standby and post power to Mine Groupment; Group 2, H₁ station; #85 Wallace and #86 843.

Generator serial No. 6604.

Kilowatts required . . . 2.6

Date of transfer of this work - 31 July 1944

Cost to date of transfer for new work at this location - \$1,130.90.

The above cost is a portion of total amount of \$40,670 set up for Job No. SF PB-21, Dir. Cons. PB-1254.

Paste on blue print showing
plan of each story of building,
giving principal dimensions
including height of ceiling.

OFFICE DIVISION
PACIFIC DIVISION
AUG 3 1944 11 05 AM
SAN FRANCISCO CALIFORNIA

8884-58