

REPORT OF COMPLETED WORKS - SEACOAST FORTIFICATIONS
(Fire Control or Torpedo Structures)

SECRET

COAST DEFENSES OF San Francisco
FORT Cronkhite, California
STRUCTURE B-51 Townsley

Form 2. Corrected to November 14, 1941.

STRUCTURE	:	:	TYPE OF DATA TRANSMISSION	:
Location	:	:Wolf Ridge, Calif., approx. 1500	Type of transmission equipment	: Telephone installed
	:	:feet north of Gun No. 1, Battery		: by Signal Corps
	:	:Townsley, and 350 feet from road-	Date of transfer	:
	:	:way.	Cost of data transmission equip-	:
Date of transfer	:	:November 14, 1941.	ment	:
Cost to that date	:	:\$2,737.86	For tide stations give descrip-	:
Type of construction	:	:	tion of tide gauge	::
(a) Roof	:	:Reinforced concrete	For datum points give Forts	:
(b) Remainder of bldg.	:	:Reinforced concrete,	from which visible	:
	:	:	For dormitories give stations	:
How concealed	:	:Earth cover and vegetation.	served.	:
How protected	:	:Earth backfill over roof.	For cable hut give S.C. type	:
Height above concealment	:	:Not above concealment		:
Height above protection	:	:Not above protection		:
Conspicuous at 400 yards	:	:Not conspicuous at sea.		:
ELECTRIC ENERGY	:	:		:
Source of electric current	:	:Battery Townsley power plant.*		:
Kilowatts required.	:	:1.20 k.w.		:
Type of lighting fixtures	:	:3 F 1		:
HEAT	:	:		:
How heated	:	:Not heated.		:
WATER AND SEWER	:	:		:
Connected to water mains	:	:No		:
Connected to sewer	:	:No		:
Type of latrine	:	:None		:
Perm. or temp. installation	:	:Permanent		:
Present condition	:	:Good		:
REFERENCE	:	:Lat. 37° 50' 25.945" - Long. 122°		:
Reference of site	:	: 32' 38.955".		:
Reference of inst. axis	:	:Elev. 663.86 M.L.L.W.		:
Elev. of inst. pedestal	:	:659.32 M.L.L.W.		:
Type of observing inst.	:	:DPF M1 Class 7 No. 80, also pier		:
	:	: mount for Model 1910 Azimuth		:
	:	: instrument.		:
Type of plotting board	:	:None		:
Type and capacity of crane	:	:None		:
Max. dim. of reel handled	:	:None		:

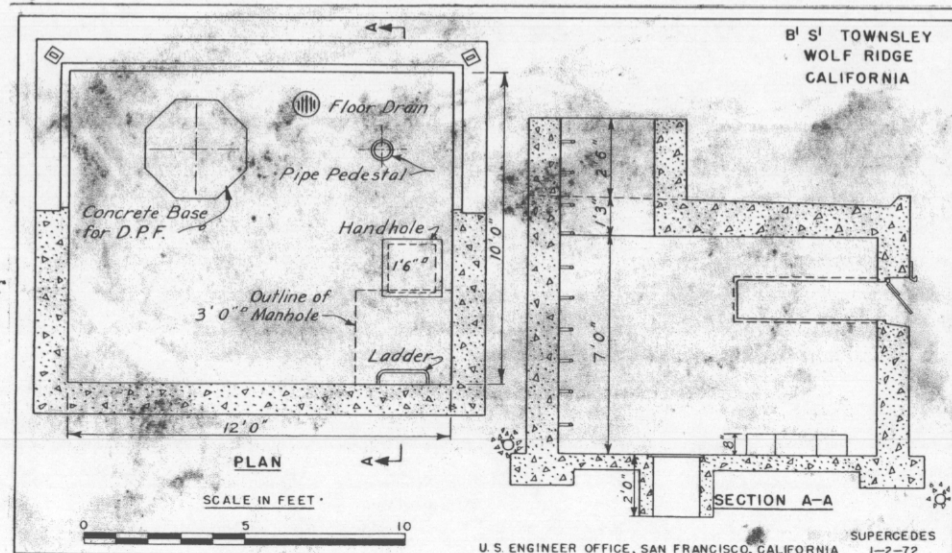

* AC comm. power to be supplied. 675.1 (San Fran) CM 8050

600.914 (Sandman)

106718

SECRET

SPEKM-1

REPORT OF COMPLETED WORKS - SEA COAST FORTIFICATIONS
(Fire Control or Torpedo Structures)

HARBOR DEFENSES OF SAN FRANCISCO
FORT CRONKHITE, CALIFORNIA
STRUCTURE B.S. TOWNSLEY *Wolf Ridge*

PART II Corrected to June 1944

STRUCTURE: x..122° 32' 38.955"
 Location (by coordinates) y...37° 50' 25.945"
 Location (by site description) *Wolf Ridge, approx.*
 Date of transfer *14 Nov. 1941* * 1500! N. Gun No. *Bett.*
 Cost to that date. \$2,737.86 *Townsley*
 Type (for observing stat.--tower, dug-in, cottages, etc.).....
 Type of construction.....
 (a) Roof ... *Reinforced Concrete*
 (b) Remainder of bldg. *Reinforced Concrete*
 How concealed .. *Earth cover and vegetation*
 How protected .. *Earth backfill over roof*
 Height above concealment .. *Not above concealment*
 Height above protection .. *Not above protection*
 Conspicuous at .. *400* yards. *Not conspicuous from* sea

UTILITIES:
 Electric Power
 Source of .. *Battery Townsley power plant*
 Characteristics: Voltage.... *Ac or DC*..Phase.....
 Kilowatts required... *1.20 KW*
 Type of lighting fixtures. *SF1*
 Heat
 How heated *Not heated*
 Water Sewer
 Connected to water mains... *No*
 Connected to sewer..... *No*
 Type latrine *None*

REFERENCE:
 Reference of site.....
 Reference of instrument axis. *Elev. 663.86 MLLW*
 Elev. Inst. Pedestal - *659.32 MLLW*

INSTRUMENTS & EQUIPMENT: D.P.F. M1 Class 7 No. 80,
 also pier mount for Model
 Type of observing inst. *1910 Azimuth instrument.*
 Type of plotting board *None*

DATA TRANSMISSION:
 Type *Telephones installed by Signal Corps.*
 Date of transfer

TIDE STATION:
 Give description of tide gauge

NOTE: This form supercedes Part II corrected to June 1944 showing station with steel dome.

* See reverse side for statement of work accomplished in 1944.

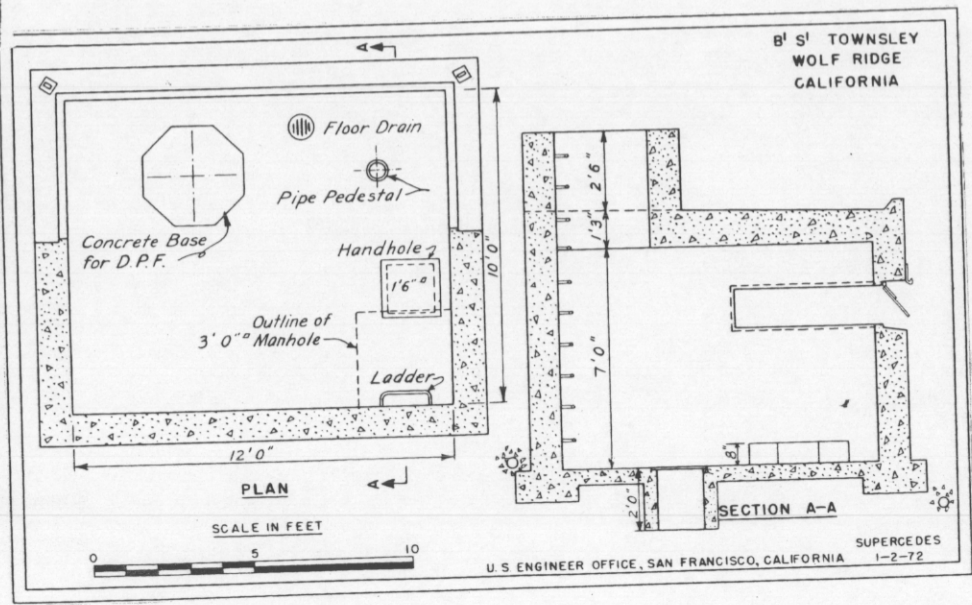

SECRET

665 (San Francisco) IN 59227

0-130
 REPORT OF COMPLETED WORKS - SEACOAST FORTIFICATIONS
 (Fire Control or Torpedo Structure)

HARBOR DEFENSES OF SAN FRANCISCO
 FORT... Ft. Cronkhite, Calif.
 STRUCTURE... Group 1

Form 2 Corrected to December 14, 1942

STRUCTURE:

Location
 Date of transfer
 Cost to that date
 Cost of Alterations:
 Type of construction
 (a) Roof
 (b) Remainder of bldg.
 How concealed
 How protected
 Height above concealment
 Height above protection
 Conspicuous at.....yards
 ELECTRIC CURRENT:
 Source of
 Kilowatts required
 Type of lighting fixtures
 HEAT:
 How heated
 WATER & SEWER:
 Connected to water mains
 Connected to sewer
 Type of latrine
 Permanent or temp. inst'n.
 Present condition

59227

Ft. Cronkhite, California
 November 14, 1941
 \$6,475.24
 \$2,093.55
 dome.
 *Reinforced concrete & steel/
 Reinforced concrete.
 Earth cover, vegetation, and
 camouflaged dome.
 Earth backfill & 1-inch steel
 dome.
 Not above concealment.
 Not above protection.
 Not conspicuous from sea.
 Battery Townsley power plant.
 2.40
 S.F. 1
 Not heated.

Lat. 37° 50' 24.500" Long. 122°
 32' 40.896"
 Elev. 588.06 MLLW
 583.60' MLLW
 None
 None

REFERENCE:

Reference of site
 Reference of inst. axis
 Elev. of inst. pedestal
 Type and capacity of crane
 Max. dim. of reel handled

INSTRUMENTS AND EQUIPMENT:

Type of observing inst.
 Type of plotting board

D.P.F. M1 Class 6 No. 136
 None

DATA TRANSMISSION:

Type of
 Date of transfer
 Cost of data transmission equip.
 For tide stations give descrip-
 tion of tide gauge
 For datum points give Forts
 from which visible
 For dormitories give sta. served
 For cable hut give S.C. type

Telephone (installed by
 Signal Corps).

*See reverse side for description
 of alterations.

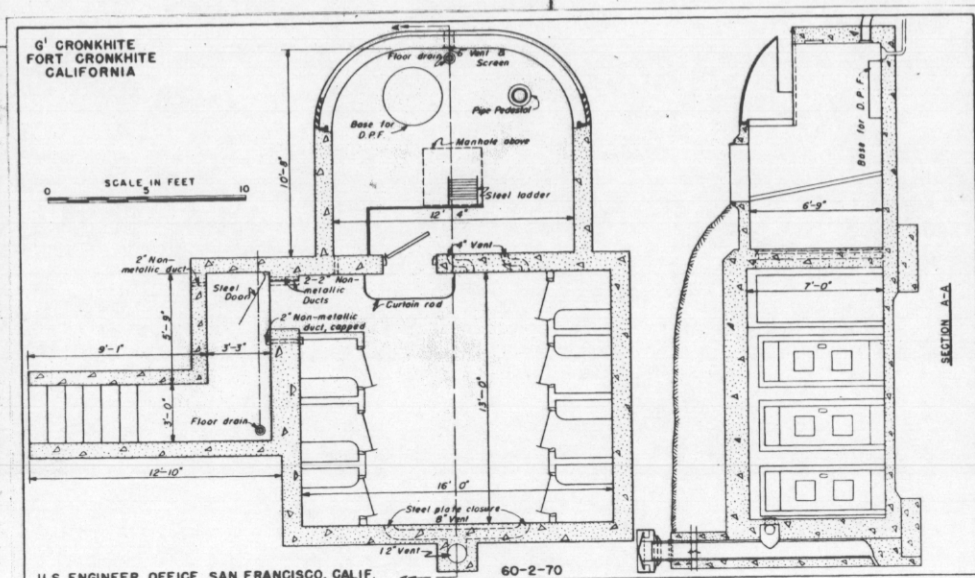

SECRET

SPEKM-1

600.914 (Sg) 105090

REPORT OF COMPLETED WORKS - SEACOAST FORTIFICATIONS
(Fire Control or Torpedo Structure)

HARBOR DEFENSES OF SAN FRANCISCO
FORT CRONKHITE, CALIFORNIA.
STRUCTURE GROUP 1

PART II Corrected to June 1944

STRUCTURE: x. 122° 52' 40.896"
 Location (by coordinates) y. 37° 50' 24.500"
 Location (by site description) Fort Cronkhite, Calif.
 Date of transfer. 14 November 1941*
 Cost to that date. \$6,475.24--Alt. \$2,093.55*
 Type (for observing stat.--tower, dug-in, cottages, etc.)
 Type of construction
 (a) Roof Reinforced concrete and steel dome*
 (b) Remainder of bldg. Reinforced concrete
 How concealed Earth cover, veg. & camouflaged dome
 How protected Earth backfill & 1 inch steel dome.
 Height above concealment Not above concealment
 Height above protection Not above protection.
 Conspicuous atyards Not conspicuous from sea.

INSTRUMENTS & EQUIPMENT:
 Type of observing inst. D.P.F. M1 Class 6, No. 136
 Type of plotting board None

DATA TRANSMISSION:
 Type Telephone (Installed by Signal Corps)
 Date of transfer

TIDE STATION:
 Give description of tide gauge

Permanent or temporary installation - Permanent.
 Present condition - new.
 * See reverse side for description of alterations completed in 1942, and work accomplished in 1944.

UTILITIES:
 Electric Power
 Source of Battery Townsley power plant.
 Characteristics: Voltage ...Ac or DC..Phase.....
 Kilowatts required. 2.40
 Type of lighting fixtures. S.F.1
 Heat
 How heated not heated
 Water Sewer
 Connected to water mains. no
 Connected to sewer. no
 Type latrine none

REFERENCE:
 Reference of site.....
 Reference of instrument axis. 585.06 MLLW
 Elev. of Inst. Pedestal - 583.60' MLLW

ED Form A-162B
16 Sept. 1943

SECRET

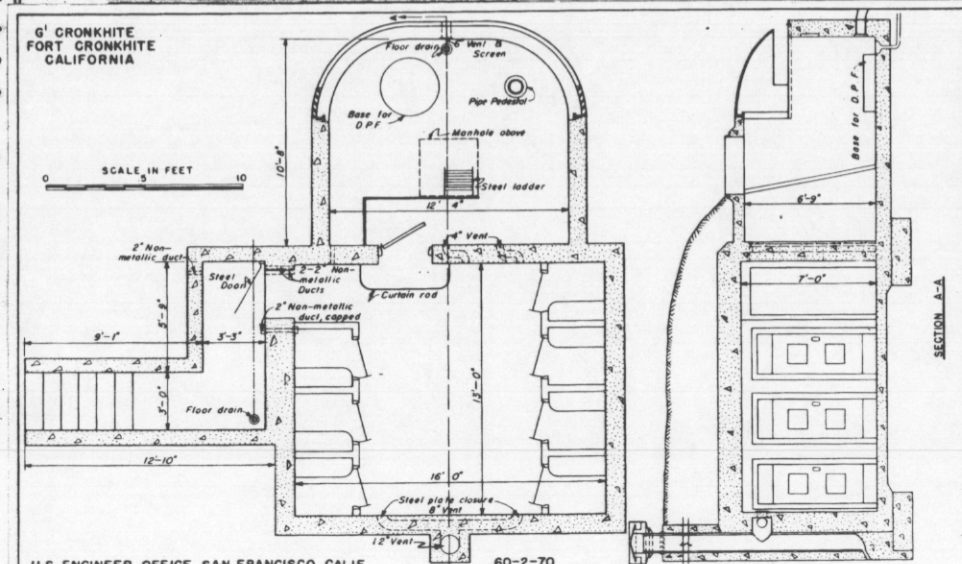

Date alterations completed - 5 October 1942.

Cost of alterations - \$2,093.55.

Nature and extent of alterations: Constructed side entrance of reinforced concrete connection to rear room of fire control station. Steel door installed at entrance to rear room.

Work Accomplished in 1944

Standby power furnished this station by 3 KVA generator No. 1, installed in new power house built under this Job No.

Existing 120 V. cable serving this station tied to one set of 2 - #1/0 VCL conductors from one of the 60 A. 2 P. D.T. switches in power house.

(See Report of Completed Works, Part II (Modified) for power house, showing size of cables, switching instructions and other information.)

Standby power. --- Voltage - 120 AC, Phase - Single.

Kilowatts required.....2.0

Date of transfer of this work--11 July 1944.

Cost to date of transfer for all work at this location incl. power house, cables etc--\$2,093.55.

This is a portion of Job No. SF 78-21, Dir. Com. 1254.

prohibited to visit here to help
mechanisms including giving
griffes to height adjustment

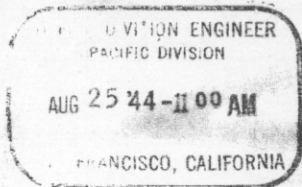

3620

3884-20

REPORT OF COMPLETED WORKS - SEACOAST FORTIFICATIONS
(Fire Control or Torpedo Structures)

Form 2.

Corrected to November 14, 1941

COAST DEFENSES OF San Francisco
Fort Cronkhite, California
Structure Group 1

SECRET

STRUCTURE		TYPE OF DATA TRANSMISSION	
Location	:Fort Cronkhite, California	Type of Transmission Equipment	: Telephone (Installed
Date of transfer	:November 14, 1941	Date of transfer	: by Signal Corps)
Cost to that date	:\$6,475.24	Cost of data transmission	:
Type of construction	:	equipment	:
(a) Roof	:Reinforced concrete and steel dome	For tide stations give descrip-	:
(b) Remainder of bldg.	:Reinforced concrete	tion of tide gauge	:
How concealed	:Earth cover, vegetation, and	For datum points give Forts	:
	: camouflaged dome	from which visible	:
If protected	:Earth backfill and 1-inch steel dome	For dormitories give stations	:
Height above concealment	:Not above concealment	saved	:
Height above protection	:Not above protection	For cable hut give S.C. type	:
Conspicuous at 400 yds.	Not conspicuous from sea		:
ELECTRIC ENERGY	:		:
Source of electric current	:Battery Townsley Power Plant *		:
Kilowatts required	:0.960KW		:
Type of lighting fixtures	:S.F.1		:
HEAT	:		:
How heated	:Not heated		:
WATER AND SEWER	:		:
Connected to water mains	:No		:
Connected to sewer	:No		:
Type of latrine	:None		:
Perm. or temp. installation	:Perm.		:
Present condition	:New		:
PREFERENCE	:		:
Reference of site	:Lat. 37° 50' 24.500" Long. 122°		:
	: 32' 40.896"		:
Reference of inst. axis	:Elev. 588.06 MLLW		:
Elev. of Inst. Pedestal	:583.60' MLLW		:
Type of observing inst.	:D.P.F. M1 Class 6 No. 136		:
Type of plotting board	:None		:
Type and capacity of crane	:None		:
Max. dim. of reel handled	:None		:

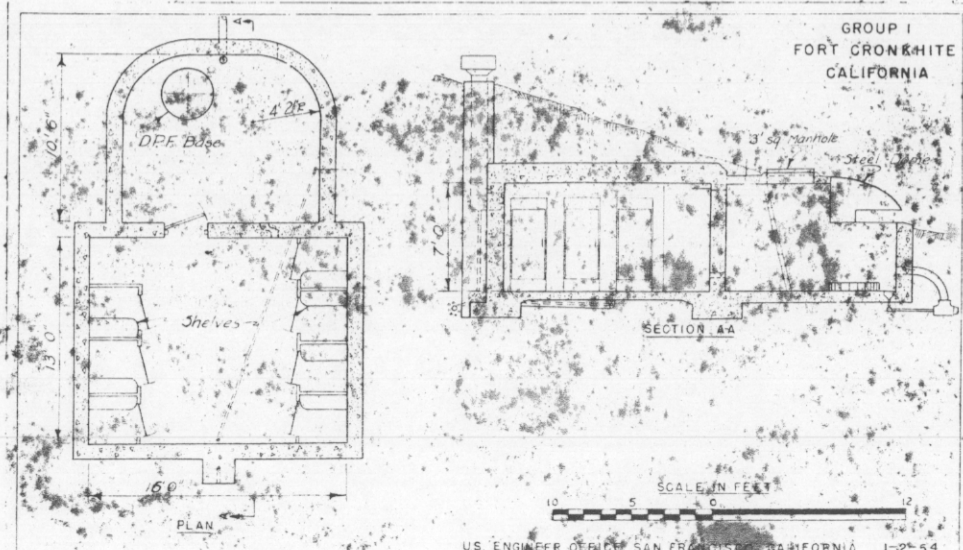

* AC comm. power to be supplied. 475.1(San Fran)CM0050

superseded: see Form 2
corrected to 14 Dec 42

SECRET

SPEKM-1

600,914 (S2)
406718

REPORT OF COMPLETED WORKS - SEACOAST FORTIFICATIONS
(Fire Control or Torpedo Structures)

HARBOR DEFENSES OF SAN FRANCISCO
FORT CRONKHITE, CALIFORNIA
STRUCTURE.. B⁴S⁴ Davis, W. Johnston

PART II Corrected to June 1944

STRUCTURE: x 122° 32' 43.833"
 Location (by coordinates) y. 37° 50' 23.900"
 Location (by site description) Wolf Ridge Approx. 1400 ft.
 Date of transfer 14 Nov. 1941 * N. Gun No. 1, Batt. Townsley
 Cost to that date. \$2,536.08
 Type (for observing stat.--tower, dug-in, cottages, etc.)
 Type of construction
 (a) Roof Reinforced Concrete
 (b) Remainder of bldg. Reinforced Concrete
 How concealed Earth cover and vegetation
 How protected Earth backfill
 Height above concealment Not above concealment
 Height above protection Not above protection
 Conspicuous at 400 yards Not conspicuous from sea

D.P.F. M1 Class 6 No. 70
 INSTRUMENTS & EQUIPMENT: Also pier mount for Model
 Type of observing inst. 1910 Azimuth instrument...
 Type of plotting board None.....

DATA TRANSMISSION:
 Type Telephones (installed by Signal Corps).....
 Date of transfer

TIDE STATION:
 Give description of tide gauge

NOTE: This form supercedes Part II Corrected to June 1944 showing station with steel dome.

UTILITIES:
 Electric Power
 Source of Battery Townsley power plant
 Characteristics: Voltage... Ac or DC..Phase
 Kilowatts required. 0.18 KW
 Type of lighting fixtures SF1
 Heat
 How heated Not heated
 Water Sewer
 Connected to water mains No
 Connected to sewer No
 Type latrine None

* See reverse side for statement of work accomplished in 1944.

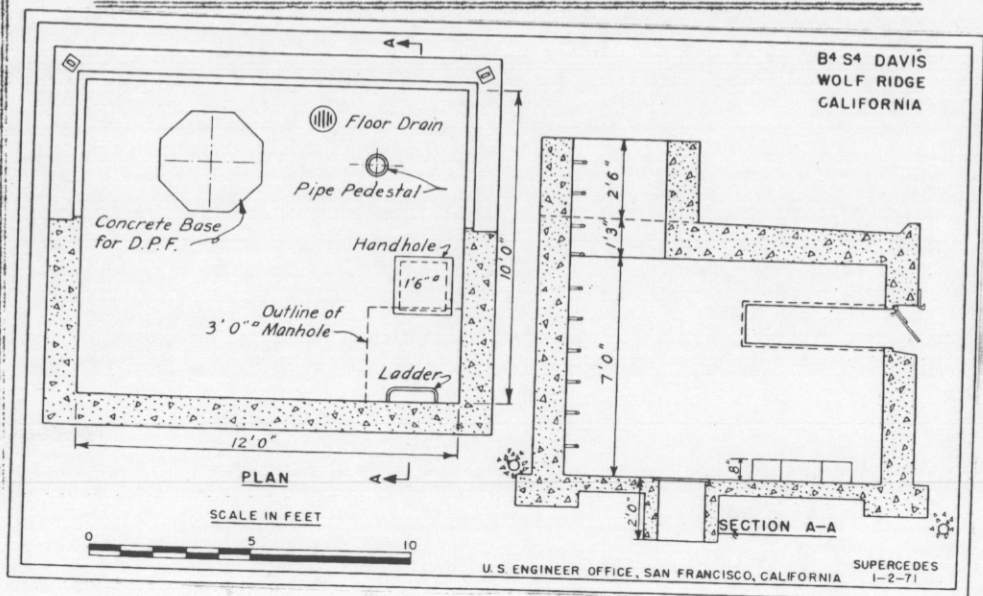

REFERENCE:
 Reference of site
 Reference of instrument axis. Elev 537.85 MLLW
 Elev Inst. Pedestal 533.31 MLLW

SECRET

817311

Work Accomplished in 1944

Standby power furnished this station by 3KVA generator, No. 1, installed in new power house built under this job no.

Existing 120V. cable serving this station tied to one set of 2-#1/0 VCL Conductors from one of the 60A. 2P. D.T. switches in power house.

(See Report of Completed Works, Part II (Modified) for power house.

Showing size of cables, switching instructions and other information).

Standby power - voltage - 120 A.C.; Phase - single.

Kilowatts required - 0.3.

Date of transfer of this work - 11 July 1944.

Cost to date of transfer for all new work at this location, including power house, cables etc. - \$2,083.58

This is a portion of Job No. SF FS-21, Directive Consecutive FS 1254.

3858

OFFICE DIVISION ENGINEER
PACIFIC DIVISION
SAN FRANCISCO, CALIF.

SEP 14 2 19 PM '44

RECEIVED

600.914 (San Fran.) CM 70003

SECRET

SPEKM-1

REPORT OF COMPLETED WORKS - SEACOAST FORTIFICATIONS

HARBOR DEFENSES OF SAN FRANCISCO
FORT .. Cronkhite, California
STRUCTURE... B' S' Constr. 129

FIRE CONTROL STATION

PART II Corrected to August 1943

STRUCTURE:
 Location (by coordinates) x...122° 32' 42.081".....
 Location (by coordinates) y...37° 50' 22.262".....
 Location (by site description).....
 Date of transfer.....25 October 1943.....
 Cost to that date...\$4,023.66.....
 Type (for observing stat.--tower, dug-in, cottages, etc.)...Dug-in.....
 Type of construction.....
 (a) RoofReinforced Concrete.....
 (b) Remainder of bldg. Reinforced Concrete.....
 How concealed ...Earth backfill & vegetation.....
 How protected ...Earth backfill.....
 Height above concealment .Not above concealment.....
 Height above protection ..Not above protection.....
 Conspicuous atyards. Not conspicuous from air or sea.

INSTRUMENTS & EQUIPMENT:
 Type of observing inst. Installed by others.....
 Type of plotting board

DATA TRANSMISSION: Telephone (Installed by others)
 Type,
 Date of transfer

TIDE STATION:
 Give description of tide gauge

Incl. 3

UTILITIES:
 Electric Power ...Yes.....
 Source of ...Post Power.....
 Characteristics: Voltage...120 Ac or DC...Phase...Single.....
 Kilowatts required...0.30.....
 Type of lighting fixtures...CFS-1.....
 Heat
 How heated ...Not heated.....
 Water Sewer
 Connected to water mains...No.....
 Connected to sewer.....No.....
 Type latrine ...None.....

REFERENCE:
 Reference of site.....535.0 MLLW.....
 Reference of instrument axis.....
 Elev. Inst. Pedestal = 531.41 (MLLW = 0.00)

ED Form A-162B
16 Sept. 1943

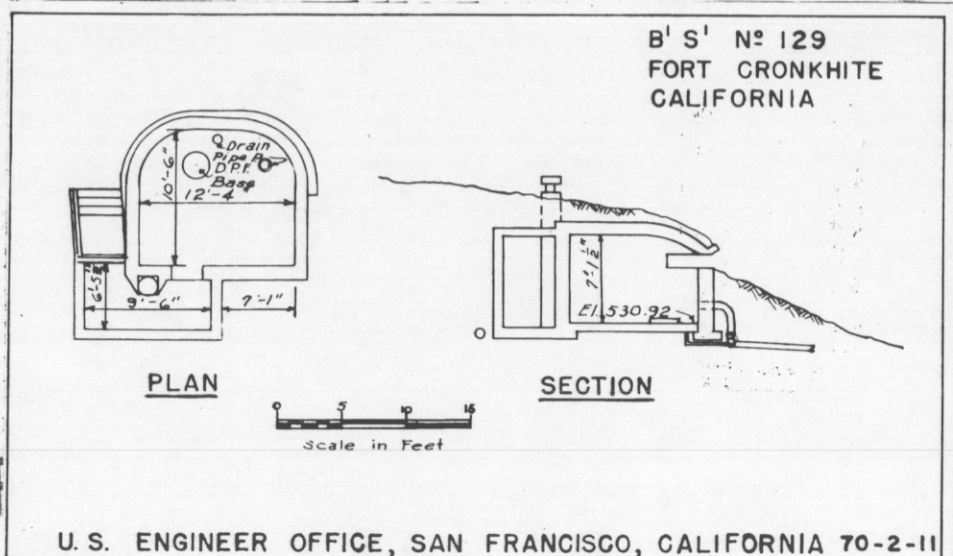

FS-500-1453 Proj Card 114

SECRET

600.914 (S²) 105090

SECRET

SPRM-1

REPORT OF COMPLETED WORKS - SEACOAST FORTIFICATIONS
FIRE CONTROL STATION

HARBOR DEFENSES OF SAN FRANCISCO
FORT CRONKHITE, CALIFORNIA
STRUCTURE... B'S' CONSTRUCTION 129. at Barry

PART II Corrected to June 1944

STRUCTURE:

Location (by coordinates) x. $122^{\circ}32'$ $42.081''$ y. $37^{\circ}50'$ $22.262''$

Location (by site description) Wolf Ridge

Date of transfer. 25 October 1943

Cost to that date. \$4,023.60

Type (for observing stat. -- tower, dug-in, cottages, etc.) Dug-in

Type of construction.

(a) Roof Reinforced Concrete.

(b) Remainder of bldg. Reinforced Concrete.

How concealed Earth backfill and vegetation.

How protected Earth backfill.

Height above concealment Not above concealment

Height above protection Not above protection

Conspicuous atyards Not conspicuous from air or sea.

INSTRUMENTS & EQUIPMENT:

Type of observing inst. Installed by others

Type of plotting board

DATA TRANSMISSION:

Type Telephone (installed by others)

Date of transfer

TIDE STATION:

Give description of tide gauge

*See reverse side for Statement of Work Accomplished in 1944.

UTILITIES:

Electric Power Yes

Source of Post Power

Characteristics: Voltage 120 Ac ~~xxxx~~ Phase Single

Kilowatts required 0.30

Type of lighting fixtures CFS-1

Heat

How heated Not heated

Water Sewer

Connected to water mains No

Connected to sewer No

Type latrine None

REFERENCE:

Reference of site 535.0 MLLW

Reference of instrument axis

Elev. inst. pedestal--531.41 (MLLW)

ED Form A-162B
16 Sept. 1943

FS 500 & 1453

SECRET

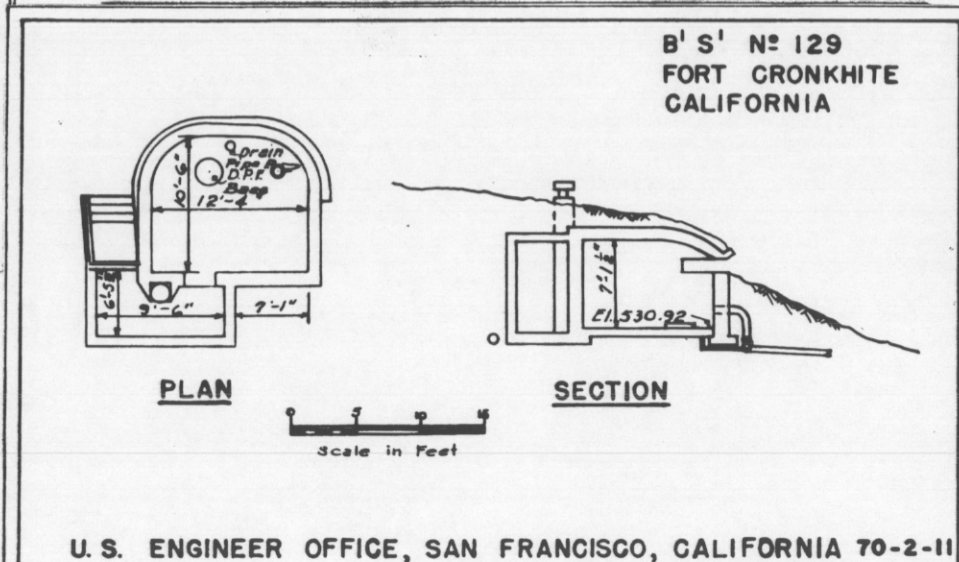

REPORT OF COMPLETED WORKS - SEACOAST FORTIFICATIONS
 (Fire Control or Torpedo Structures)
 Form 2. Corrected to November 14, 1941

COAST DEFENSES OF San Francisco
 Tennessee Point, California (Fl. Cronkhite)
 STRUCTURE B² S² Rathbone (6) - M² Indoc (7)

STRUCTURE	:	: TYPE OF DATA TRANSMISSION	:
Location	: Tennessee Point, California	: Type of transmission equipment	: Telephone (Installed by
Date of transfer	: November 14, 1941	: Date of transfer	: Signal Corps)
Cost to that date	: \$3,734.53	: Cost of data transmission	:
Type of construction	:	: equipment	:
(a) Roof	: Reinf. conc. and steel dome	: For tide stations give descrip-	:
(b) Remainder of bldg.	: Reinforced concrete	: tion of tide gauge	:
How concealed	: Earth cover, vegetation, and camou-	: For datum points give Forts	:
	: flaged dome	: from which visible	:
How protected	: Earth backfill and one inch thick	: For dormitories give stations	:
	: steel dome	: served	:
Height above concealment	: Not above concealment	: For cable hut give S.C. type	:
Height above protection	: Not above protection	:	:
Conspicuous at 400 yds.	: Not conspicuous from sea	:	:
ELECTRIC ENERGY	:	:	:
Source of electric current	: None	:	:
Kilowatts required	: None	:	:
Type of lighting fixtures	: None	:	:
HEAT	:	:	:
How heated	: Not heated	:	:
WATER AND SEWER	:	:	:
Connected to water mains	: No	:	:
Connected to sewer	: No	:	:
Type of Latrine	: None	:	:
Perm. or temp. installation	: Perm.	:	:
Present condition	: New	:	:
REFERENCE	:	:	:
Reference of site	: Lat. 37° 50' 08.708" Long. 122° 32'	:	:
	: 47.234"	:	:
Reference of inst. axis	: 223.68' M.L.L.W.	:	:
Elev. of Ins. Pedestal	: 219.02' M.L.L.W. CM	:	:
Type of observing inst.	: D.P.F. Lewis M1907 No./105. Also	:	:
	: pier mount for M1910 Azimuth inst	:	:
Type of plotting board	: None	:	:
Type and capacity of crane	: None	:	:
Max. dim. of reel handled	: No reel	:	:

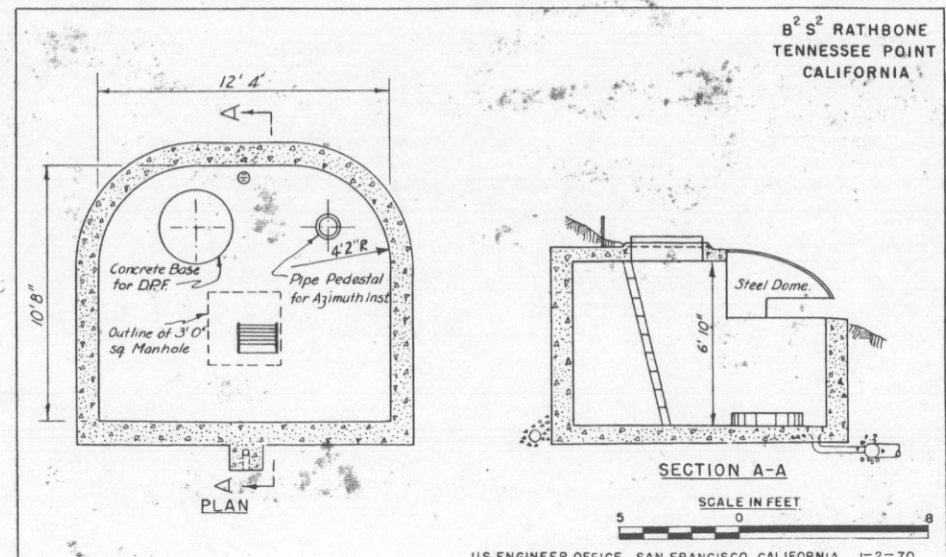

REPORT OF COMPLETED WORKS - SEACOAST FORTIFICATIONS
(Fire Control or Torpedo Structures)

COAST DEFENSES OF San Francisco
Tennessee Point, California *Ft. Cronkhite*
STRUCTURE B₂ S₂ Guthrie *at Barry*

Form 2. Corrected to November 14, 1941

STRUCTURE	:	:TYPE OF DATA TRANSMISSION	:
Location	:Tennessee Point, California	:Type of Transmission Equipment	:Telephone (Installed
Date of transfer	:November 14, 1941	:Date of Transfer	: by Signal Corps)
Cost to that date	:\$1,876.87	:Cost of data transmission equip-	:
Type of construction	:	: ment	:
(a) Roof	:Reinforced concrete	:For tide stations give descrip-	:
(b) Remainder of bldg.	:Reinforced concrete	: tion of tide gauge	:
How concealed	:Rock, earth cover and vegetation	:For datum points give Forts	:
How protected	:Earth backfill	: from which visible	:
Height above concealment	:Not above concealment	:For dormitories give stations	:
Height above protection	:Not above protection	: served	:
Conspicuous at 1000 yds.	:Not conspicuous from sea	:For cable hut give S.C. type	:
ELECTRIC ENERGY	:	:	:
Source of electric current	:Tennessee Point Search Light Power	:	:
	: Plant	:	:
Kilowatts required	:0.12 KW	:	:
Type of lighting fixtures	:Eng. Type. Standard outlet and	:	:
	: armored cable.	:	:
HEAT	:	:	:
How heated	:Not heated	:	:
WATER AND SEWER	:	:	:
Connected to water mains	:No	:	:
Connected to sewer	:No	:	:
Type of latrine	:None	:	:
Perm. or temp. installation	:Perm.	:	:
Present condition	:Good	:	:
Elevation of site	:94.0 M.L.L.W.	:	:
Reference of inst. axis	:85.1 M.L.L.W. BM	:	:
Type of observing inst.	:D.P.F Lewis M'07 No./63 Also pier	:	:
	:mount for M 1910 Aximuth Instrument	:	:
Type of plotting board	:None	:	:
Type and capacity of crane	:None	:	:
Max. dim. of reel handled	:None	:	:

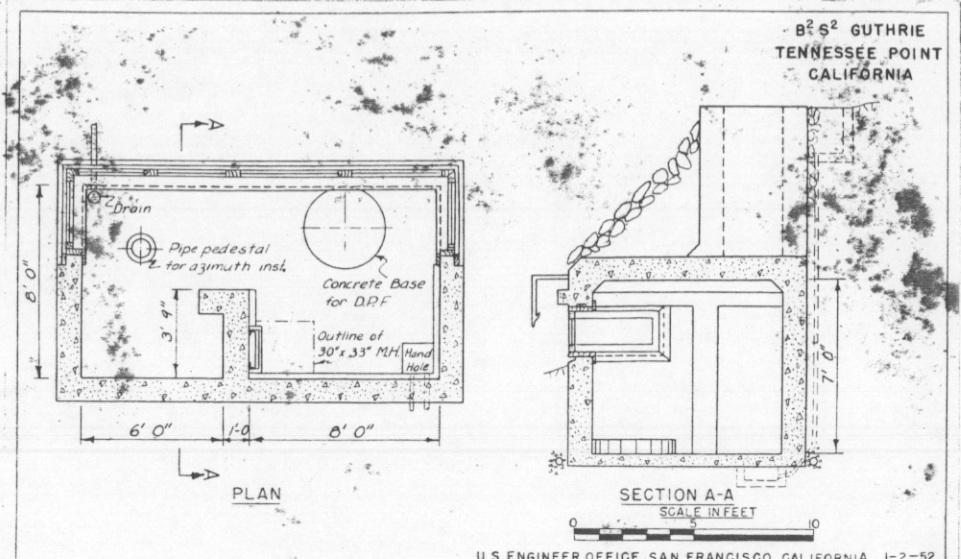

REPORT OF COMPLETED WORKS -- SEACOAST FORTIFICATIONS.
(Fire control or Torpedo Structures)

HARBOR
~~XXXX~~ DEFENSES OF SAN FRANCISCO.
FORT... ~~BARRY~~ *Cronkhite.. (Tenn. Pt.)*.....
STRUCTURE... ~~B¹ ALEXANDER~~.....

Form 2. Corrected to NOV 1927

B² S₃ Guthrie

Location	: On bluff in front of S.L. #16, Tennessee Point Res.	Type of data transmission	: Telephone.
Date of transfer	: June 28, 1917.	Date of transfer	: With station.
Cost to that date	: \$943.30.	Cost of data transmission	: Furnished by Sig. Corps.
Type of construction	:	equipment	:
(a) Roof	: Concrete.	For tide stations give description of tide gauge	:
(b) Remainder of bldg.	: Concrete.	For datum points give Forts from which visible	:
How concealed	: Earth parapet.	For dormitories give stations served	:
How protected	: Earth parapet.	For cable hut give S.C. Type	:
Heights above concealment	: 4.3'	:	:
Heights above protection	: 4.3'	:	:
Conspicuous at 1500 yards	: from sea.	:	:
Source of electric current	: Power plant for S.L. 16 & Tennessee Pt. Res.	:	:
Kilowatts required	: 12 k.w.	:	:
Type of lighting fixtures	: W.T. fix. and arm. cable.	:	:
How heated	: Not heated.	:	:
Connected to water mains	: No.	:	:
Connected to sewer	: Yes.	:	:
Type of latrine	: No latrine.	:	:
Permanent or temporary installation	: Permanent.	:	:
Present condition	: Good.	:	:
Reference of site	: 94.0	:	:
Reference of instrument axis	: 85.1 above M.L.L.V.	:	:
Type of observing inst.	: Swasey D.P.F. Type A.	:	:
Type of plotting board	:	:	:
Type and capacity of crane	:	:	:
Max. dimensions of reel handled	:	:	:

*Superseded - see Form 2
corrected to 17 Nov 41*

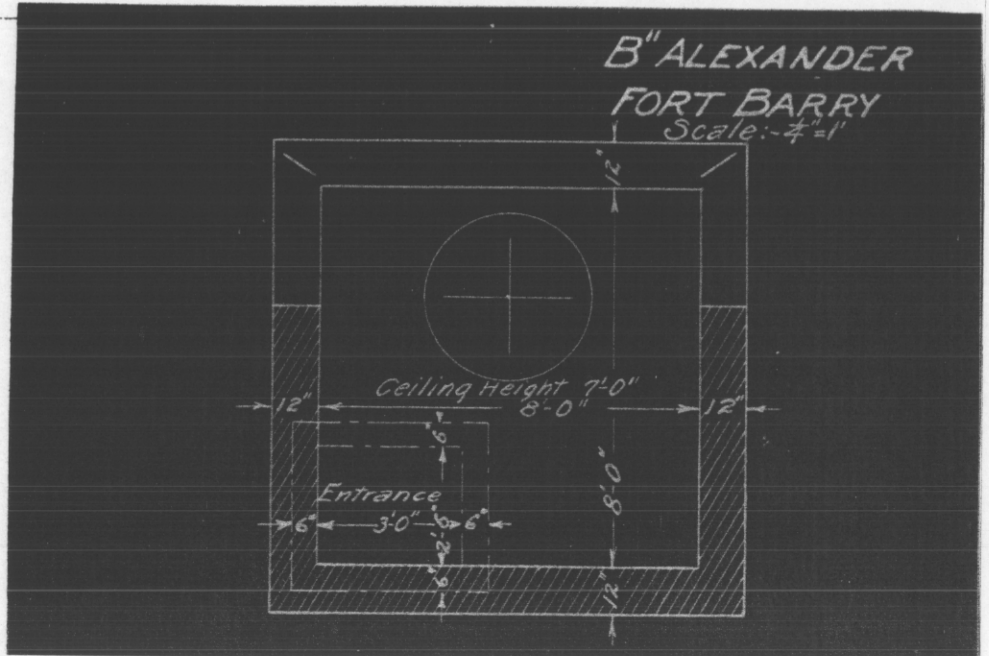

REPORT OF COMPLETED WORKS -- SEACOAST FORTIFICATIONS.
(Fire control or Torpedo Structures)

HARBOR

~~COAST~~ DEFENSES OF SAN FRANCISCO.

FORT. ~~BARRY~~ Cronkhite... (Tenn. Pt.).....
STRUCTURE... ~~E. WALLACE~~.....

Form 2.

Corrected to NOV 1 1927

M² Mines

Location	180-ft. contour, Tennessee Point Reservation	Type of data transmission	Telephone.
Date of transfer	June 24, 1921.	Date of transfer	With station.
Cost to that date	\$1,173.58	Cost of data transmission	Supplied by Sig. Corps.
Type of construction		equipment	
(a) Roof	Concrete.	For tide stations give description of tide gauge	
(b) Remainder of bldg.	"	For datum points give Forts from which visible	
How concealed	Earth	For dormitories give stations served	
How protected	"	For cable hut give S.C. Type	
Heights above concealment	0: Observing slot in face of bluff.		
Heights above protection	3'-0"		
Conspicuous at	600 yards: At sea.		
Source of electric current	Power plant, S.L. 16 & 17.		
Kilowatts required	.12-k.w.		
Type of lighting fixtures	Stand. W.T. fix. & Arm. cable		
How heated	Not heated.		
Connected to water mains	No.		
Connected to sewer	Drained to slope.		
Type of latrine	None.		
Permanent or temporary installation	Permanent.		
Present condition	Good.		
Reference of site	178.80' above M.L.L.W.		
Reference of instrument axis	178.74 " "		
Type of observing inst.	Swasey D.P.F. A II.		
Type of plotting board			
Type and capacity of crane			
Max. dimensions of reel handled			

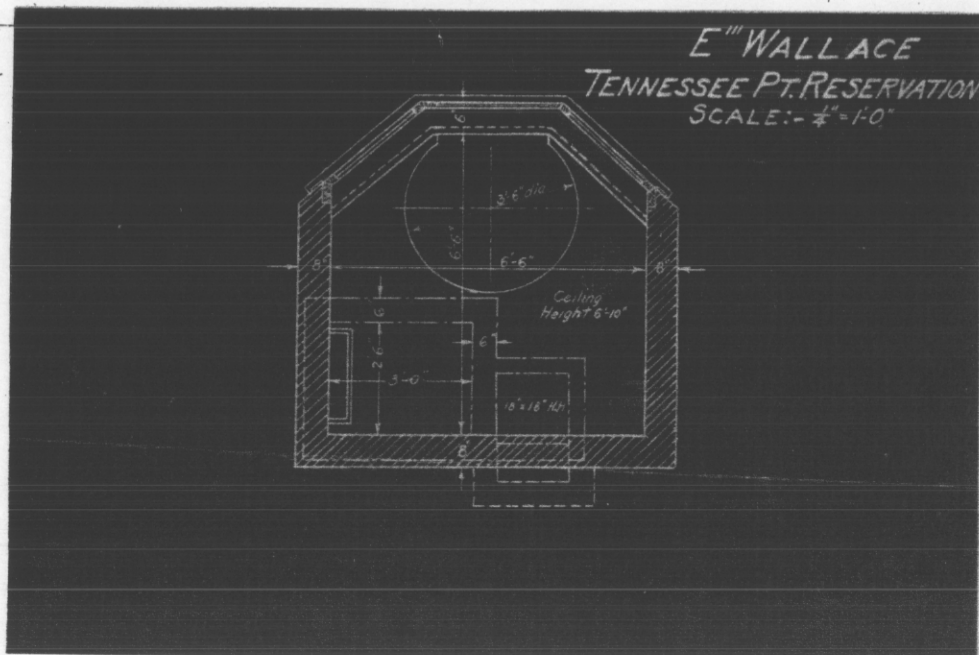

Obsolete

REPORT OF COMPLETED WORKS -- SEACOAST FORTIFICATIONS.
(Fire control or Torpedo Structures)

HARBOR DEFENSES OF SAN FRANCISCO.
~~COAST~~ FORT BARRY... *Crankhite... (Tenn. Pt.)*...
STRUCTURE B" MENDELL.....

Form 2. Corrected to NOV 1 1927

Location	On bluff, 110 ft. to left of S.L.#16 Shelter, Tennessee Point.	Type of data transmission	Telephone.
Date of transfer	June 28, 1917.	Date of transfer	With station.
Cost to that date	\$944.57	Cost of data transmission	
Type of construction		equipment	Furnished by Sig.Corps
(a) Roof	Concrete.	For tide stations give description of tide gauge	
(b) Remainder of bldg.	Concrete.	For datum points give Forts from which visible	
How concealed	By earth parapet.	For dormitories give stations served	
How protected	By earth parapet.	For cable hut give S.C-Type	
Heights above concealment	4.3'		
Heights above protection	4.3'		
Conspicuous at 1500 yards	from sea.		
Source of electric current	S.L.#16 and #17 power plant.		
Kilowatts required	.12 k.w.		
Type of lighting fixtures	W.T.fixtures, arm.cable.		
How heated	Not heated.		
Connected to water mains	No.		
Connected to sewer drain	Yes.		
Type of latrine	No latrine.		
Permanent or temporary installation	Permanent.		
Present condition	Good.		
Reference of site	91.0		
Reference of instrument axis	85.1 above M.L.L.W.		
Type of observing inst.	Swasey D.P.F., Type A.		
Type of plotting board			
Type and capacity of crane			
Max. dimensions of reel handled			

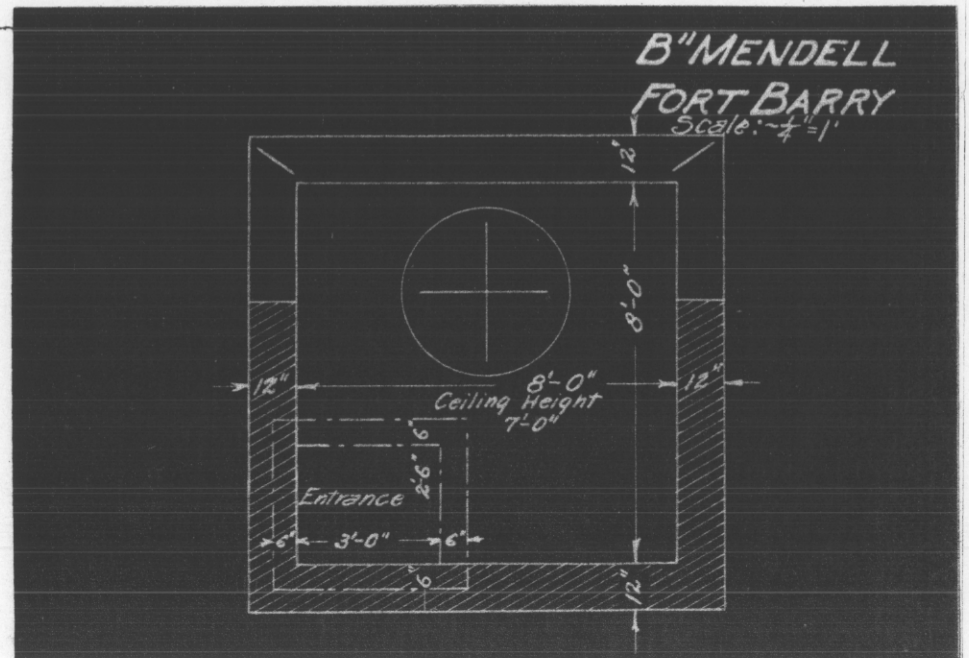

REPORT OF COMPLETED WORKS - SEACOAST FORTIFICATIONS
(Fire Control or Torpedo Structures)

COAST DEFENSES OF San Francisco
FORT Cronkhite, California
STRUCTURE B⁴S⁴ Davis
12-12

SECRET

Form 2. Corrected to November 14, 1941.

STRUCTURE	: Wolf Ridge, Calif., approximately	TYPE OF DATA TRANSMISSION	:
Location.	: 1400 feet north of Gun No. 1 at	Type of transmission equipment	: Telephone installed
	: Battery Townsley, and 100 feet		: by Signal Corps
	: from fork in road.	Date of transfer	:
Date of transfer	: November 14, 1941.	Cost of data transmission equip-	:
Cost to that date	: \$2,536.08	ment	:
Type of construction	:	For tide stations give descrip-	:
(a) Roof	: Reinforced concrete	tion of tide gauge	:
(b) Remainder of bldg.	: Reinforced concrete	For datum points give Forts from:	:
	:	which visible	:
How concealed	: Earth cover and vegetation		:
How protected	: Earth backfill over roof		:
Height above concealment	: Not above concealment		:
Height above protection	: Not above protection		:
Conspicuous at <u>400</u> yards	: Not conspicuous from sea.		:
ELECTRIC ENERGY	:		:
Source of electric current	: Battery Townsley power plant *		:
Kilowatts required	: 1.20 k.w.		:
Type of lighting fixtures	: S F 1		:
HEAT	:		:
How heated	: Not heated		:
WATER AND SEWER	:		:
Connected to water mains	: No		:
Connected to sewer	: No		:
Type of latrine	: None		:
Perm. or temp. installation	: Permanent		:
Present condition	: Good		:
REFERENCE	:		:
Reference of site	: Lat. 37° 30' 23.900", Long. 122°		:
	: 32' 43.833"		:
Reference of inst. axis	: Elev. 537.85' M.L.L.W.		:
Elev. of inst. pedestal	: 533.31' M.L.L.W.		:
Type of observing inst.	: DPF M.1 Class 6 No. 70, also		:
	: pier mount for Model 1910		:
	: Azimuth instrument		:
Type of plotting board	: None		:
Type and capacity of crane	: None		:
Max. dim. of reel handled	: None		:

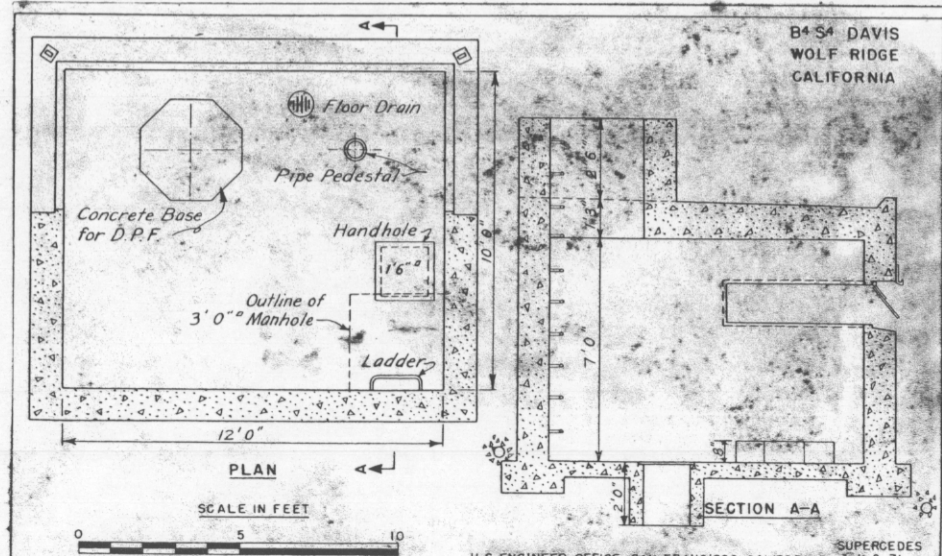

* AC comm. power to be supplied. 675.1 (San Fran) CM 0050

600.914 (San Fran) 102114

SECRET

SPEKM-1

REPORT OF COMPLETED WORKS - SEACOAST FORTIFICATIONS
Fire Control Station

HARBOR DEFENSES OF SAN FRANCISCO
ELK VALLEY
FORT
STRUCTURE

PART II Corrected to April 1944

STRUCTURE: x... 122° 33' 07.131"
y... 37° 50' 21.836"
Location (by coordinates) Elk Valley
Location (by site description) 29 November 1943
Date of transfer
Cost to that date \$5,945.15
Type (for observing stat. tower, dug-in, cottages, etc.) Dug-in
Type of construction Reinforced concrete
(a) Roof Reinforced concrete
(b) Remainder of bldg. Earth backfill & vegetation
How concealed Earth backfill
How protected Not above concealment
Height above concealment Not above protection
Height above protection Not conspicuous
Conspicuous at yards

INSTRUMENTS & EQUIPMENT: Installed by others
Type of observing inst.
Type of plotting board

DATA TRANSMISSION: Installed by Signal Corps
Type
Date of transfer

TIDE STATION:
Give description of tide gauge

*See reverse side for statement of work done in 1944.

UTILITIES: To be installed (Sepr. const.)
Electric Power Standby Power Plant
Source of 120
Characteristics: Voltage...Ac or DC...Phase 3
Kilowatts required CIS-1
Type of lighting fixtures
Heat Not heated
How heated
Water Sewer
Connected to water mains No
Connected to sewer No
Type latrine None

REFERENCE:
Reference of site 177.00 MLIN
Reference of instrument axis
Elev. Inst. Ped. 172.60 (MLIN = 0.00)

ED Form A-162B
16 Sept. 1943

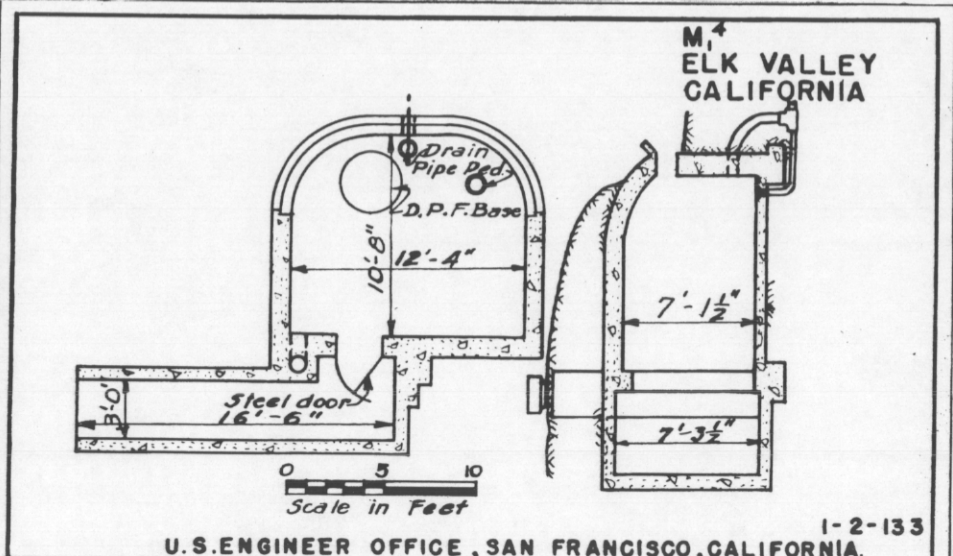

SECRET

SECRET

SPEKM-1

600,914 (San Fran) CW 72312

REPORT OF COMPLETED WORKS - SEACOAST FORTIFICATIONS

Fire Control Station

HARBOR DEFENSES OF SAN FRANCISCO
PORT Elk Valley, Calif. - Ft. Cronkhite
STRUCTURE M1 Station

PART II Corrected to September 1943

STRUCTURE: x... 122° 33' 07.131"
 Location (by coordinates) y... 37° 50' 31.836"
 Location (by site description) Elk Valley
 Date of transfer... 29 November 1943
 Cost to that date... \$ 5945.45
 Type (for observing stat.--tower, dug-in, cottages, etc.)... Dug-in
 Type of construction.....
 (a) Roof... Reinforced Concrete
 (b) Remainder of bldg. Reinforced Concrete
 How concealed... Earth backfill and vegetation
 How protected... Earth Backfill
 Height above concealment Not above concealment
 Height above protection Not above protection
 Conspicuous atyards Not conspicuous

INSTRUMENTS & EQUIPMENT:
 Type of observing inst. ... Installed by others
 Type of plotting board

DATA TRANSMISSION: Installed by Signal Corps
 Type
 Date of transfer

TIDE STATION:
 Give description of tide gauge

UTILITIES:
 Electric Power ... To be installed (separate constr.)
 Source of Standby Power Plant
 Characteristics: Voltage 120 Ac or DC Phase 3
 Kilowatts required.....
 Type of lighting fixtures... CFS-1
 Heat
 How heated Not heated
 Water Sewer
 Connected to water mains... No
 Connected to sewer..... No
 Type latrine None

REFERENCE:
 Reference of site... 177.0 MLLW
 Reference of instrument axis.....
 Elev. Inst. Ped. - 172.60 (MLLW= 0.00)

ED Form A-162B
16 Sept. 1943

Proj. Cad 128 15425, 1453

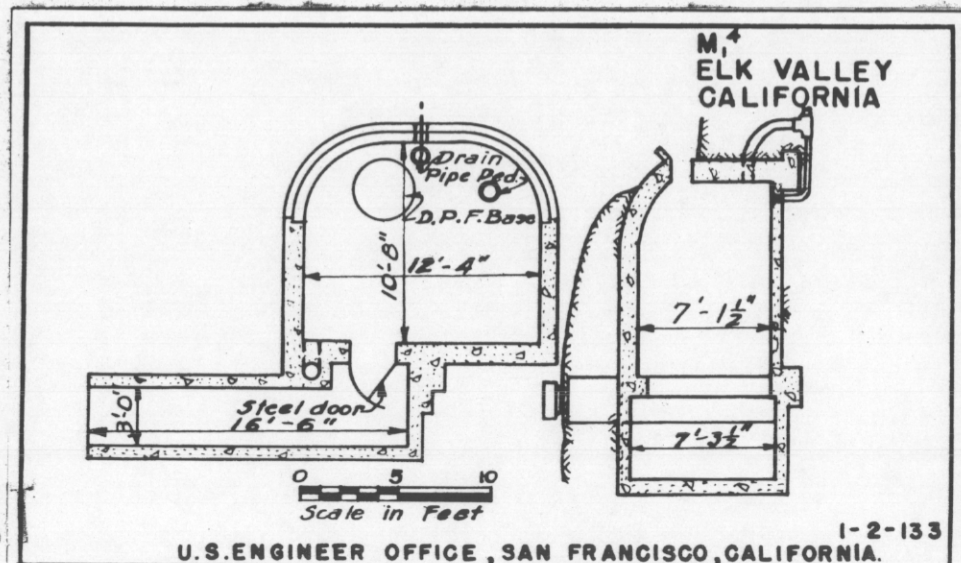

SECRET

CONFIDENTIAL

SPEKM-1

89908 REPORT OF COMPLETED WORKS - SEACOAST FORTIFICATIONS.

Mine Cable Line

89908 Part VI

Corrected to March 1944

HARBOR DEFENSES OF San Francisco
PORT. Elk Valley. (Sta. M-1 to Cable
Hut at Elk Valley)

~~ENGINEER DEPARTMENT STRUCTURES~~

On this sheet list any existing structures of a permanent or semipermanent nature used wholly or in part by the Engineer Department, such as wharves, storehouses, quarters, office buildings, railroads and railroad equipment, giving for each a short description, dimensions, materials of construction, present use, location, etc., and cost if known.

Installation of Cable Job No. Elk Valley FS-2, Direct. Cons., F.S.-1049, lead covered, double jute impregnated, armour sheathed 3 conductor cable (Furnished by Signal Corps), group of 3 cables installed in existing man holes (numbered 1 to 15 consecutively) between Mine Casemate M-1 and M.H. #15 at Rodeo Lagoon, and by direct burial, between M.H. #15 and existing cable hut at Elk. 12,925 lin.ft. of group of 3 cables installed. (4,340 lin.ft. in existing duct and 8,585 lin.ft. direct burial.)

Costs to date of transfer \$26,531.11. Date of transfer 17 April 1944.

Directive Ref. letter O.C.E. 26 May 1943, subject: "Construction Pertaining to Submarine Mine Project H.D.S.F.," file C of E 663(San Francisco)Ref. C.M.39872.

See Proj. Card 155

CONFIDENTIAL